



HAZEL G COOK ELEMENTARY SCHOOL PEDESTRIAN IMPROVEMENTS KELLOGG ELEMENTARY SCHOOL PEDESTRIAN IMPROVEMENTS

IN THE CITY OF CHULA VISTA, CALIFORNIA
(CIP # TRF0384 AND STL0410)

GENERAL NOTES:

- EXISTING UTILITIES ARE SHOWN ON THE PLAN IN THEIR APPROXIMATE LOCATION AND EXTENT. UNDERGROUND UTILITIES MAY EXIST, WHICH ARE NOT OF RECORD OR WHICH HAVE NOT BEEN REPORTED. THE CONTRACTOR SHALL TAKE DUE PRECAUTIONARY MEASURES TO PROTECT THOSE FACILITIES AND STRUCTURES FOUND AT THE SITE. THE CONTRACTOR SHALL NOTIFY:
SAN DIEGO GAS AND ELECTRIC CO-----858-654-8339
AT&T -----619-266-4725
COX CABLE TV -----619-263-1032
ACCESS CABLE -----760-460-4604
OTAY WATER DISTRICT-----619-670-2285
SWEETWATER AUTHORITY -----619-409-6751
CITY OF CHULA VISTA-----619-397-6000
ALLIED WASTE SERVICES (TRASH PICKUP)-----619-421-9400
CROWN CASTLE -----626-320-0996
(NOTIFICATION TO BE 48 HOURS PRIOR TO STARTING WORK.)
- THE PERPETUATION OF EXISTING HORIZONTAL AND VERTICAL CONTROL AND PROPERTY MONUMENTS WILL BE DONE BY THE CITY SURVEYING GROUP UNLESS THERE IS A BID ITEM IN THE CONTRACT PROPOSAL FOR THE CONTRACTOR TO DO IT. ANY PROPERTY MONUMENTS DESTROYED BY THE CONTRACTOR'S NEGLIGENCE MUST BE REPLACED AT HIS/HER OWN EXPENSE. CITY BENCH MARKS AND INTERSECTION TIES WILL BE REFERENCED AND REPLACED BY THE CITY SURVEYING GROUP.
- THE LOCATION AND ELEVATION OF EXISTING IMPROVEMENTS TO BE MET (OR AVOIDED) BY THE WORK TO BE DONE SHALL BE CONFIRMED BY THE CONTRACTOR'S FIELD MEASUREMENTS PRIOR TO THE CONSTRUCTION OF NEW WORK. THE CONTRACTOR SHALL REPORT TO THE OWNER ANY DISCREPANCIES BETWEEN HIS/HER MEASUREMENTS AND THESE PLANS.
- THE CONTRACTOR AGREES THAT HE OR SHE SHALL ASSUME SOLE AND COMPLETE RESPONSIBILITY FOR JOB SITE CONDITIONS DURING THE COURSE OF CONSTRUCTION OF THIS PROJECT, INCLUDING THE SAFETY OF ALL PERSONS AND PROPERTY. THIS REQUIREMENT SHALL APPLY CONTINUOUSLY AND NOT BE LIMITED TO NORMAL WORKING HOURS. THE CONTRACTOR SHALL DEFEND, INDEMNIFY, AND HOLD THE OWNER AND THE CITY REPRESENTATIVES HARMLESS FROM ANY AND ALL LIABILITY, REAL/OR ALLEGED, IN CONNECTION WITH THE PERFORMANCE OF WORKING ON THIS PROJECT.
- NEW CONSTRUCTION IS SHOWN BOLD LINES AND EXISTING IMPROVEMENTS ARE SHOWN IN LIGHT LINES. USE ALL NEW EQUIPMENT AND HARDWARE EXCEPT WHEN NOTED IN THE PLAN, SCHEDULE OR SPECIFICATION. ALL OTHER EQUIPMENT SHALL REMAIN IN PLACE.
- THE CONTRACTOR IS RESPONSIBLE FOR THE VERIFICATION OF ELECTRICAL AND/OR TELEPHONE SERVICE POINTS FOR THIS PROJECT. THE CONTRACTOR IS ALSO RESPONSIBLE FOR THE INSTALLATION OF ALL NECESSARY MATERIALS IN ACCORDANCE WITH SDG&E AND/OR AT&T REQUIREMENTS.
- DELIVER ALL SPARE EQUIPMENT AND OTHER SALVAGED APPURTENANCES TO PUBLIC WORKS CENTER AT:
1800 MAXWELL ROAD
CHULA VISTA, CA 91911
- ANY STRIPING DAMAGED OR DESTROYED DURING CONSTRUCTION SHALL BE REPLACED BY THE CONTRACTOR AT HIS/HER EXPENSE.

IMPORTANT NOTICE

SECTION 4216/4217 OF THE GOVERNMENT CODE REQUIRES A DIG ALERT IDENTIFICATION NUMBER TO BE ISSUED BEFORE A "PERMIT TO EXCAVATE" WILL BE VALID. TO OBTAIN A DIG ALERT IDENTIFICATION NUMBER, CALL UNDERGROUND SERVICE ALERT
TOLL FREE 8-1-1
TWO WORKING DAYS BEFORE YOU DIG.

SPECIFICATIONS

- THE IMPROVEMENTS CONSIST OF THE FOLLOWING WORK TO BE DONE IN ACCORDANCE WITH THESE PLANS AND THE FOLLOWING:
- 2012 CITY OF CHULA VISTA SUBDIVISION MANUAL
 - STANDARD SPECIFICATIONS FOR PUBLIC WORKS CONSTRUCTION, 2012 EDITION ("GREENBOOK")
 - 2012 REGIONAL SUPPLEMENT TO STANDARD SPECIFICATIONS FOR PUBLIC WORKS CONSTRUCTION ("REGIONAL SUPPLEMENT")
 - SAN DIEGO REGIONAL STANDARD DRAWINGS ("SDRSD"), DATED SEPTEMBER 2012
 - CITY OF CHULA VISTA STANDARD SPECIAL PROVISIONS (CV SPECIAL PROVISIONS), DATED APRIL 2019
 - CITY OF CHULA VISTA DESIGN AND CONSTRUCTION STANDARD DRAWINGS 2017 ("CVSD")
 - CALIFORNIA DEPARTMENT OF TRANSPORTATION STANDARD PLANS 2015 ("CALTRANS STANDARD PLANS")
 - CALIFORNIA DEPARTMENT OF TRANSPORTATION STANDARD SPECIFICATIONS 2015 ("CALTRANS STANDARD SPECIFICATIONS")
 - 2014 CALIFORNIA MANUAL ON UNIFORM TRAFFIC CONTROL DEVICES, REVISION 5 ("MUTCD")

IMPROVEMENT:	STANDARD DWG. NO.	SYMBOL:
1. SAFETY LIGHTING/LED LUMINAIRE	CVSD-TRF-08	
2. TRAFFIC SIGNAL STANDARD, MAST ARM, RSNS, VIDEO, VEHICLE INDICATIONS, SIGN, AND LED LUMINAIRE	PER PLAN	
3. EMERGENCY VEHICLE PREEMPTION (EVPE)	PER PLAN	
4. REFLECTORIZED STREET NAME SIGNS (RSNS)	CALTRANS STD PLAN ES-33	
5. PEDESTRIAN INDICATION	PER PLAN	
6. CONTROLLER CABINET	CHULA VISTA & CALTRANS SPECS	
7. SERVICE POINT	PER PLAN	
8. UTILITY BOX	PER PLAN	
9. METER PEDESTAL SDG&E APPROVED	PER PLAN, CHULA VISTA SPECS.	
10. VEHICLE/BICYCLE DETECTION ZONE (LOOPS)	PER PLAN	
11. MANHOLE	PER PLAN	
12. CONDUIT	CVSD-TRF-09	
13. EXISTING CONDUIT	PER PLAN	
14. PAVEMENT MARKING LEGEND	PER PLAN	
15. ADA PEDESTRIAN RAMPS WITH TRUNCATED DOMES	CVSD-GSI-08	
16. APPROXIMATE PROPERTY LINE	PER PLAN	
17. SIGN ON POST	PER PLAN	
18. SIGN ON TRAFFIC SIGNAL EQUIPMENT	PER PLAN	
19. PULL BOX	CVSD-TRF-09	
20. CONCRETE		
21. LANDSCAPING		
22. EXISTING WATER LINE		
23. EXISTING GAS LINE		
24. EXISTING TELEPHONE LINE		
25. EXISTING ELECTRIC LINE		
26. EXISTING CABLE LINE		
27. EXISTING SEWER LINE		
28. EXISTING FIRE HYDRANT		
29. EXISTING POWER POLE		

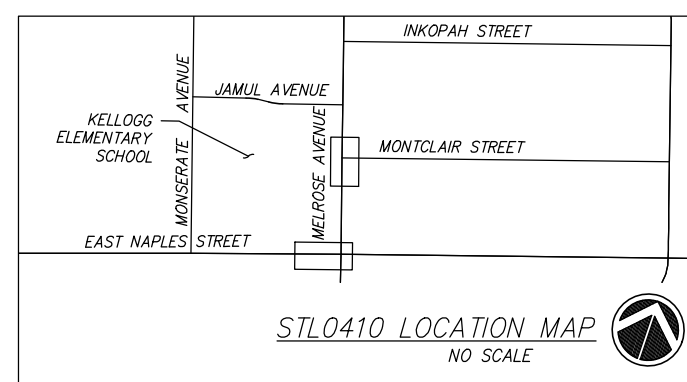
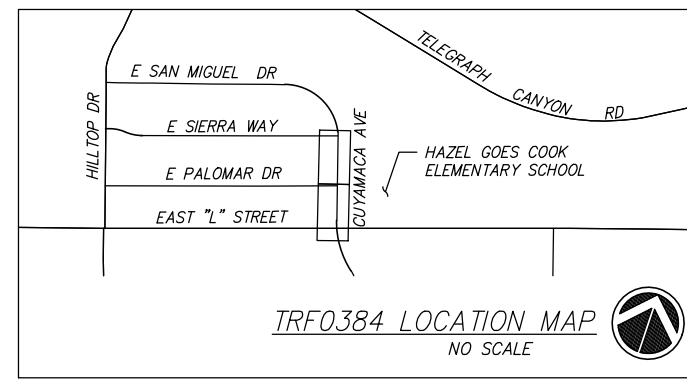
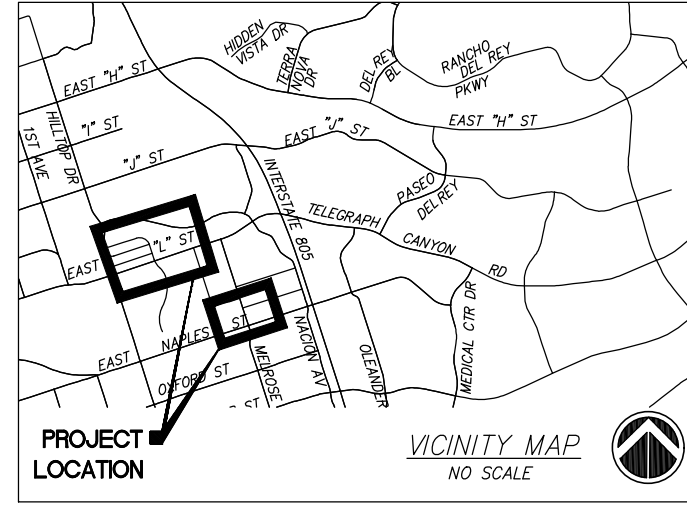

DECLARATION OF RESPONSIBLE CHARGE

I HEREBY DECLARE THAT I AM THE ENGINEER OF WORK FOR THIS PROJECT, THAT I HAVE EXERCISED RESPONSIBLE CHARGE OVER THE DESIGN OF THE PROJECT AS DEFINED IN SECTION 6703 OF THE BUSINESS AND PROFESSIONS CODE AND THAT THE DESIGN IS CONSISTENT WITH CURRENT STANDARDS.

CITY OF CHULA VISTA
276 FOURTH AVENUE
CHULA VISTA, CALIFORNIA 91910

BY: Rosina Constanza DATE: 5/28/2020
ROSINA C. CONSTANZA, RCE 86105, EXP. 9-30-2020

SHEET NO.	SHEET TITLE
1	TITLE SHEET
2	GENERAL NOTES & DETAILS
3	GENERAL IMPROVEMENT PLAN - KELLOGG (STL0410)
4	IMPROVEMENT PLAN - HAZEL G COOK (TRF0384)
5	SIGNING & STRIPING PLAN - HAZEL G COOK (TRF0384)
6	TRAFFIC SIGNAL PLAN - HAZEL G COOK (TRF0384)

**HAZEL G COOK ELEMENTARY SCHOOL PEDESTRIAN IMPROVEMENTS
KELLOGG ELEMENTARY SCHOOL PEDESTRIAN IMPROVEMENTS**

TITLE SHEET
GENERAL NOTES

UTILITY NOTE: ALL EXISTING UTILITIES SHOWN ON THESE PLANS ARE PLOTTED FROM RECORD DATA AT THEIR APPROXIMATE LOCATIONS. UNDERGROUND FACILITIES MAY EXIST WHICH HAVE NOT BEEN REPORTED OR ARE NOT OF RECORD. CONTRACTOR SHALL VERIFY THE LOCATION OF ALL PERTINENT UTILITIES IN THE FIELD PRIOR TO THE START OF CONSTRUCTION.

RESPONSIBLE CHARGE OF WORK: DATE: 5/28/2020
Rosina Constanza

APPROVED BY: DATE: 5/28/2020
JOSE LUIS GOMEZ P.E., P.L.S.
PRINCIPAL CIVIL ENGINEER

CITY OF CHULA VISTA
ENGINEERING AND CAPITAL PROJECTS
276 FOURTH AVENUE
CHULA VISTA, CA 91910
WWW.CHULAVISTA.CA.GOV

DRAWING NO.
18010-01

TOTAL SHEETS: 06
TRF0384/STL0410

3. REVISION 1. BY / DATE
2. BY / DATE
1. BY / DATE

DESIGNED BY: YFL
DRAWN BY: YFL
CHECKED BY: RCC

SCALE
HORIZONTAL: N/A
VERTICAL: N/A

DATUM
HORIZONTAL: CCS '83 ZONE 6, EPOCH 1991.35
VERTICAL: NAVD83

PROJECTS/17384 - Cook Elem - CAD - Production/17384-001.dwg
PLOT DATE: 5/27/2020 4:31 PM
PLOT BY: TAN LU

CONSTRUCTION RECORD	AS-BUILT
CONTRACTOR:	SIGNED:
INSPECTOR:	DATE:
DATE COMPLETED:	DISCIPLINE:
	PRINTED NAME:
	R.C.E. NO.:
	EXPIRATION:

