

SITE PLAN

- - - PROPERTY LINE
- - - EDGE OF EXISTING PAVEMENT
- - - EXISTING RIGHT OF WAY
- - - EXISTING WATER LINE
- CONCRETE WALKS
- CONCRETE DRIVE
- PLANTING + GROUND COVER
MYOPORUM ROSEMARY
PINK MUHLY ORCHID ROCKROSE

- 1 BUILDING ENTRY
- 2 SCREENED TRASH + RECYCLING AREA
- 3 PERSONNEL GATE
- 4 SECURITY FENCE
- 5 GENERATOR
- 6 PATIO
- 7 PERSONNEL PARKING (20 SPACES)
- 8 ROLLING SECURITY GATE
- 9 PUBLIC PARKING (2 SPACES)
- 10 BIO-RETENTION BASIN
- 11 HOSE DRYING RACK
- 12 TRANSFORMER
- 13 WALKING PATH
- 14 PEDESTRIAN RAMP
- 15 6" CURB + GUTTER TYP. STREET FRONT
- 16 NEW CROSSWALK
- 17 CUL-DE-SAC
- 18 SWEETWATER AUTHORITY PRIMARY WATER LINE TO REMAIN IN DRIVE
- 19 FIRE STATION SIGNALING + STRIPING

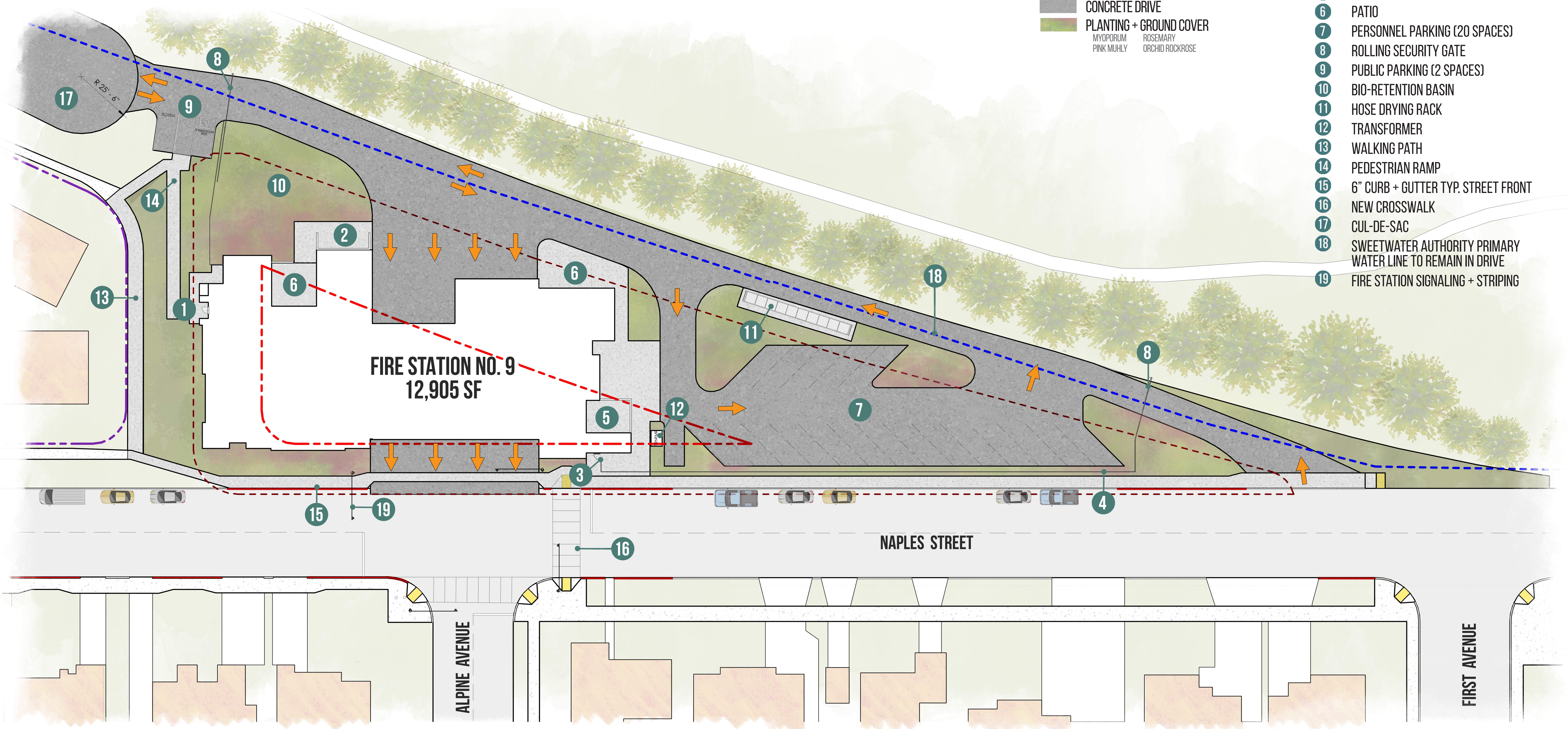

FIRE STATION NO. 9
12,905 SF

NAPLES STREET

ALPINE AVENUE

FIRST AVENUE

SOUTH ELEVATION



**CITY OF CHULA VISTA
FIRE STATION NO. 9**

VIEW FROM NAPLES STREET



**CITY OF CHULA VISTA
FIRE STATION NO. 9**

VIEW FROM MOSS STREET CUL-DE-SAC



**CITY OF CHULA VISTA
FIRE STATION NO. 9**

VIEW FROM NAPLES STREET



**CITY OF CHULA VISTA
FIRE STATION NO. 9**