

Q:\CIVIL_3D\PROJECTS\ALL PROJECTS\STL399 - SOUTH BAY BRT\MAINTAGREEMENT\SHITS\00-TITLE\00-TITLE.DWG - 1/8/2019 7:55:35 AM

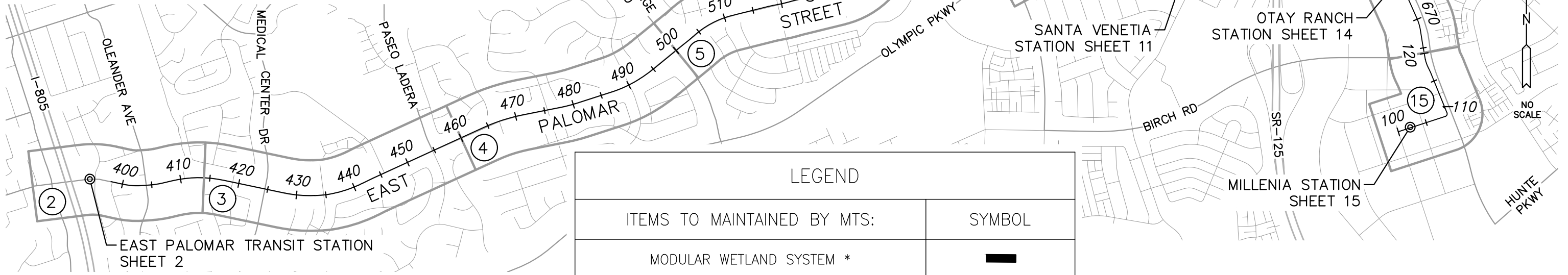

SHEET KEY LEGEND

SHEET LIMITS AND NUMBER

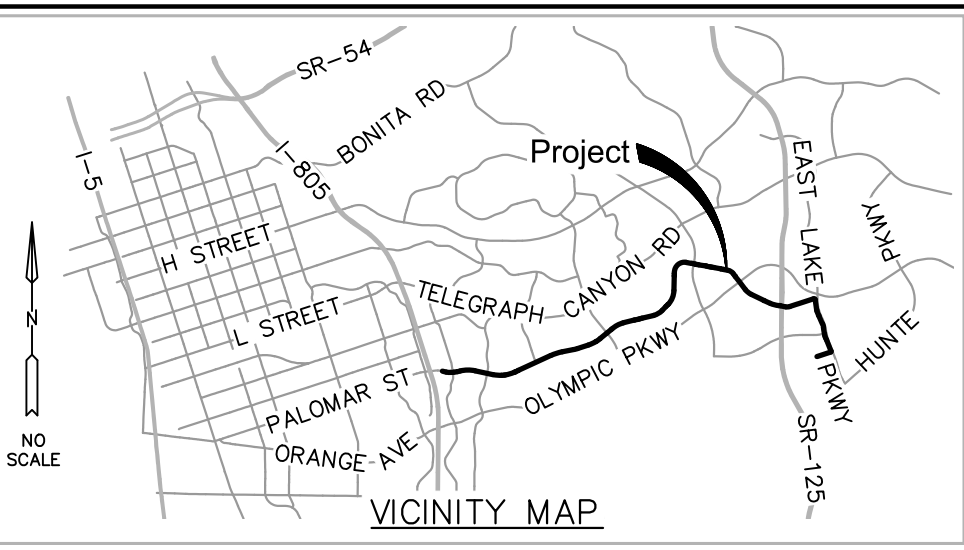
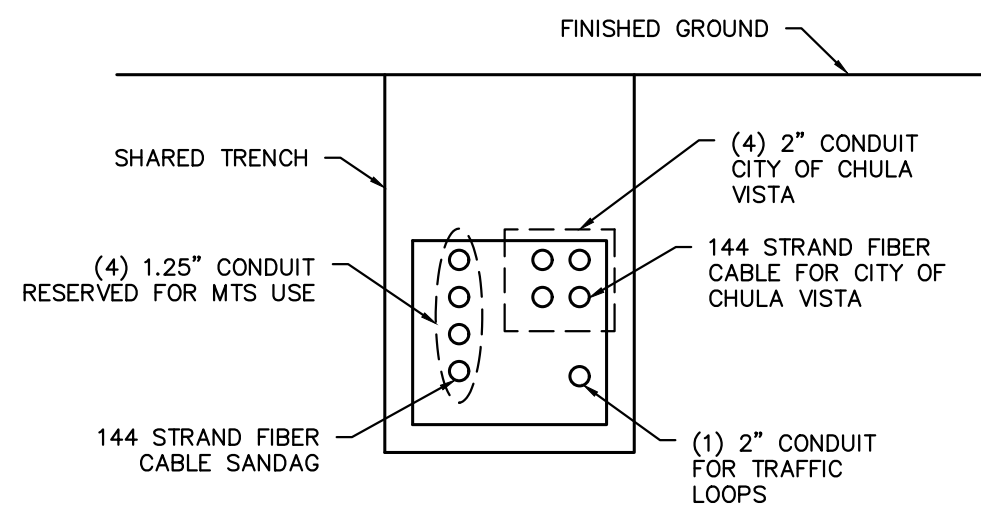

CITY OWNED SHARED CONDUIT TRENCH DETAIL
 FOR ADDITIONAL DETAILS AND TRENCH LOCATIONS SEE
 SOUTHBAY BRT CONSTRUCTION DRAWINGS

LEGEND	
ITEMS TO MAINTAINED BY MTS:	SYMBOL
MODULAR WETLAND SYSTEM *	
UNDERGROUND DETENTION VAULT *	
MEDIAN DETENTION SWALE *	
UNDERGROUND INFILTRATION UNIT *	
BIORETENTION BASIN *	
MODULAR UNDERGROUND TANK SYSTEM *	
CDS UNIT *	
INLET FILTER (WHEN IDENTIFIED) *	
RETAINING WALL	
SOUND WALL	
TRAFFIC SIGNAL SYSTEM	
DEDICATED GUIDEWAY & STATIONS	

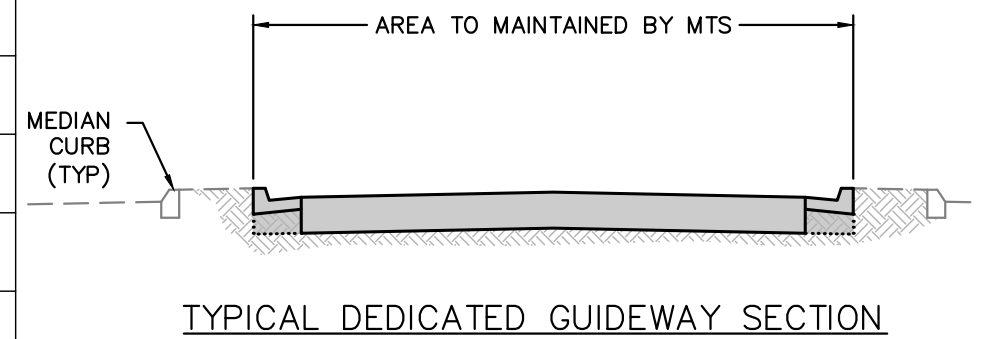

NOTE: PROJECT IS IN CONSTRUCTION PHASE. ADDITIONAL WALLS AND OTHER APPURTENANCES TO BE CONSTRUCTED AND ASBUILT WILL BE ADDED TO THESE EXHIBITS AS CONSTRUCTION PROGRESSES.



JANUARY 2019

* DRAINAGE AND STORM WATER QUALITY ITEMS

EXHIBIT A
 SOUTH BAY RAPID
 MAINTENANCE AGREEMENT
 KEY MAP & LEGEND
 SHEET 1 OF 15

Scale: 1" = 200'

Q:\CIVIL_3D\PROJECTS\ALL PROJECTS\STL399 - SOUTH BAY RPT\MAINTAGREEMENT\SHITS\01-PH1_DAR-HERIT_KHA\SBRT-MA01-01.DWG - 1/8/2019 7:57:39 AM

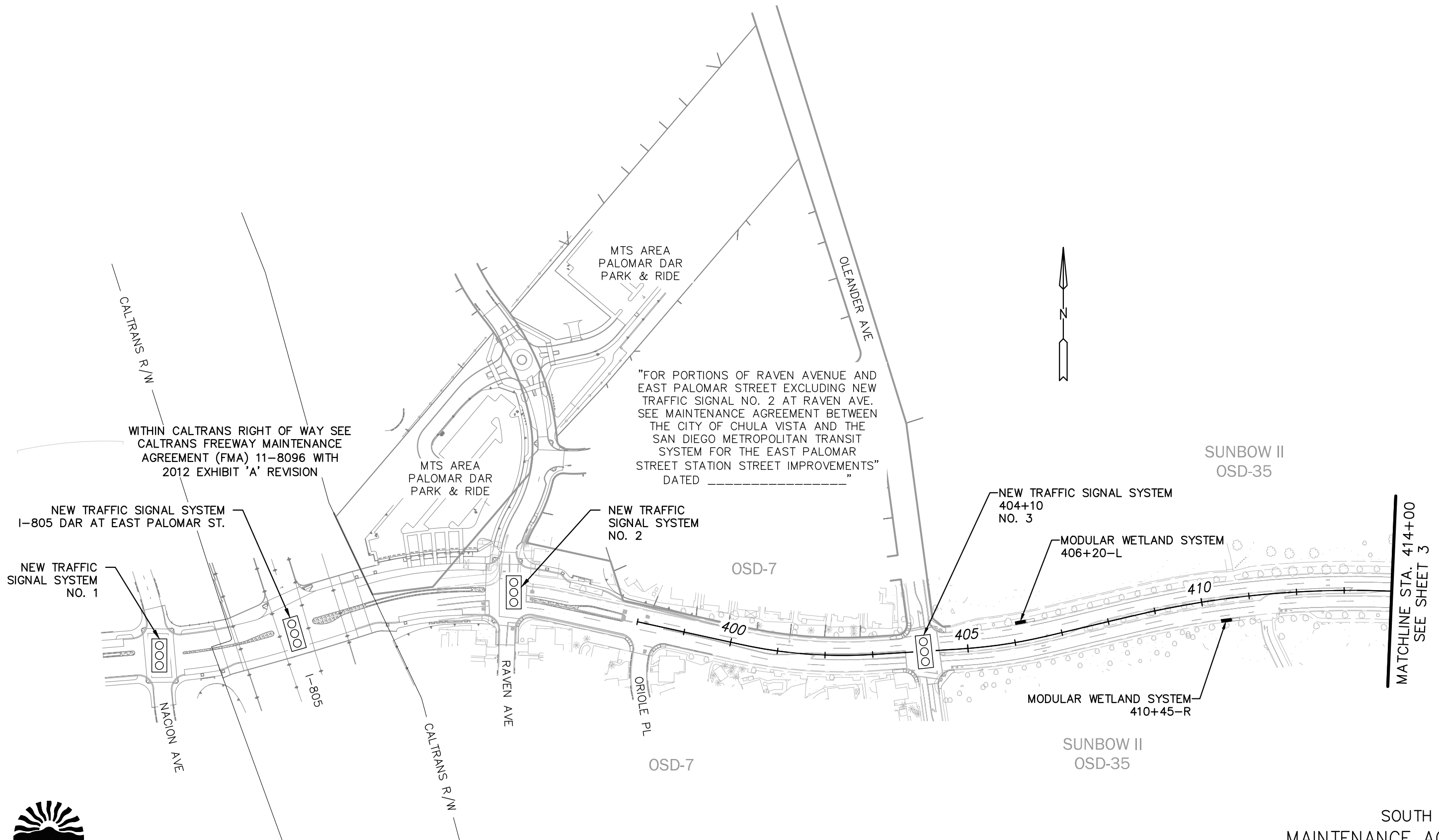

"FOR PORTIONS OF RAVEN AVENUE AND EAST PALOMAR STREET EXCLUDING NEW TRAFFIC SIGNAL NO. 2 AT RAVEN AVE. SEE MAINTENANCE AGREEMENT BETWEEN THE CITY OF CHULA VISTA AND THE SAN DIEGO METROPOLITAN TRANSIT SYSTEM FOR THE EAST PALOMAR STREET STATION STREET IMPROVEMENTS" DATED _____

WITHIN CALTRANS RIGHT OF WAY SEE CALTRANS FREEWAY MAINTENANCE AGREEMENT (FMA) 11-8096 WITH 2012 EXHIBIT 'A' REVISION

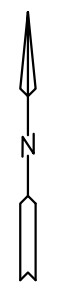

MATCHLINE STA. 414+00
SEE SHEET 3



JANUARY 2019

SOUTH BAY RAPID
MAINTENANCE AGREEMENT
EAST PALOMAR TRANSIT STATION I-805 DAR TO GOULD AVE
SHEET 2 OF 15

Scale: 1" = 200'

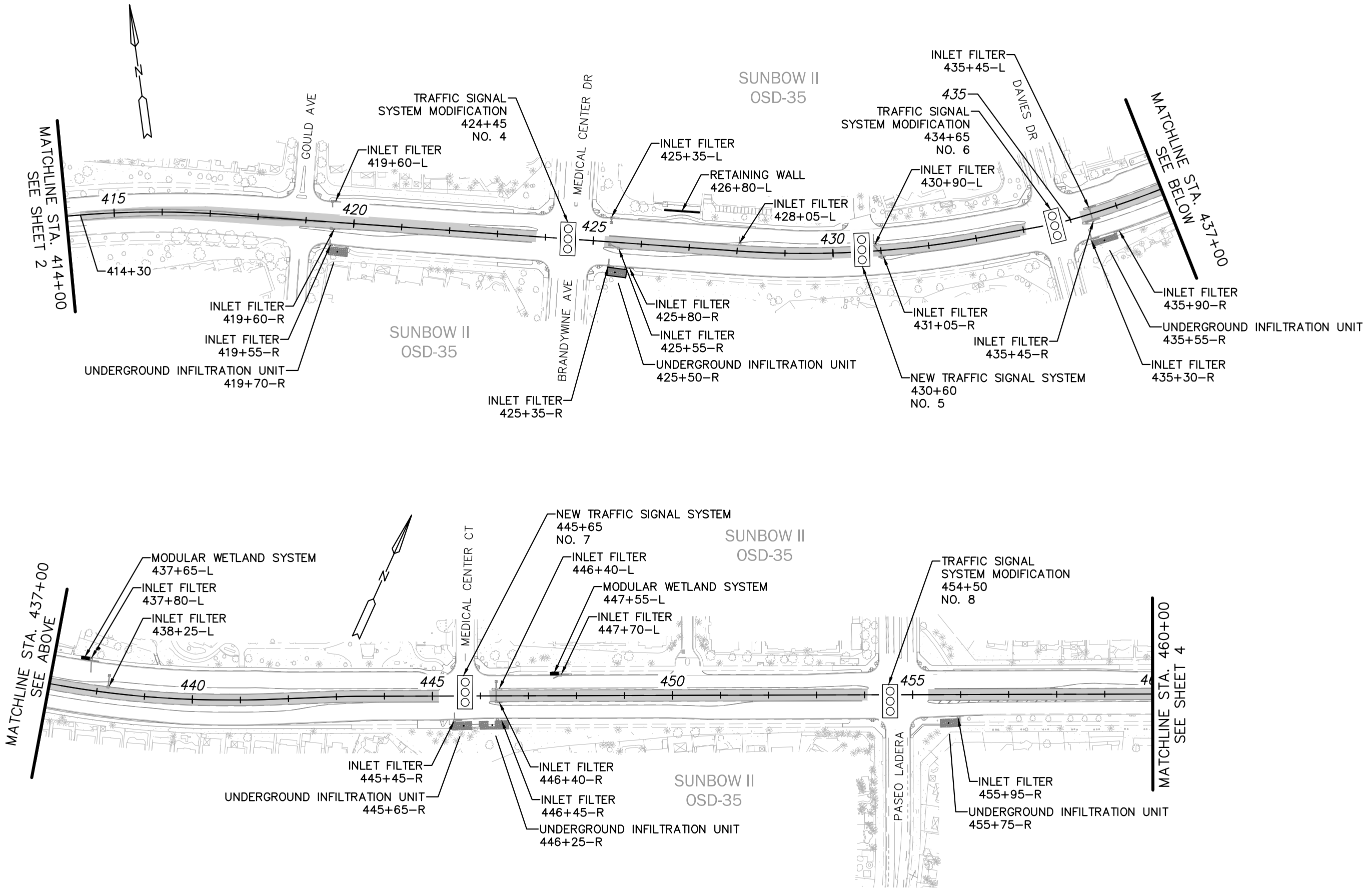

Q:\CIVIL 3D\PROJECTS\ALL PROJECTS\STL399 - SOUTH BAY BRT\MAINTENANCE\SHITS\01-PH1_DAR-HERIT_KHA\SBBRT-MA01-01.DWG - 1/8/2019 8:00:36 AM



JANUARY 2019

SOUTH BAY RAPID
 MAINTENANCE AGREEMENT
 GOULD AVE TO PASEO LADERA
 SHEET 3 OF 15

Scale: 1" = 200'

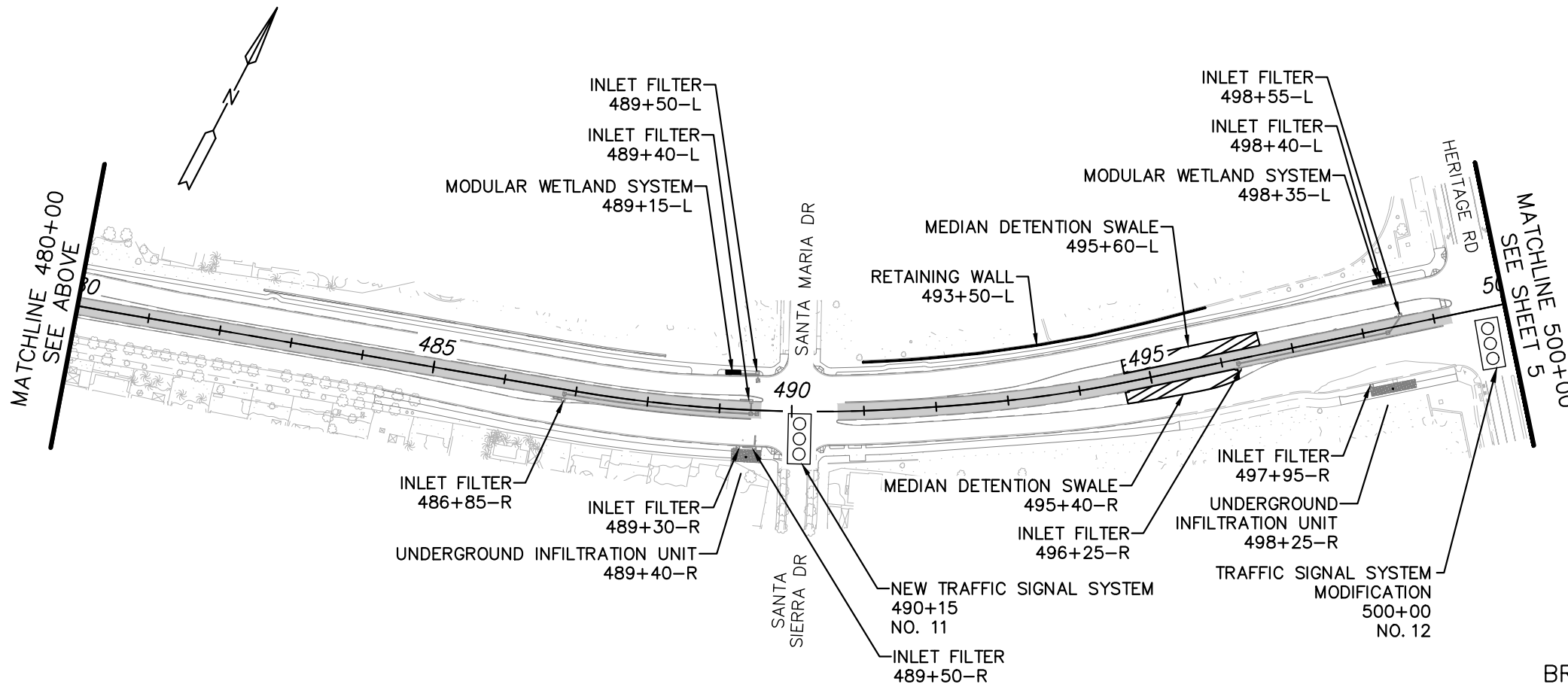
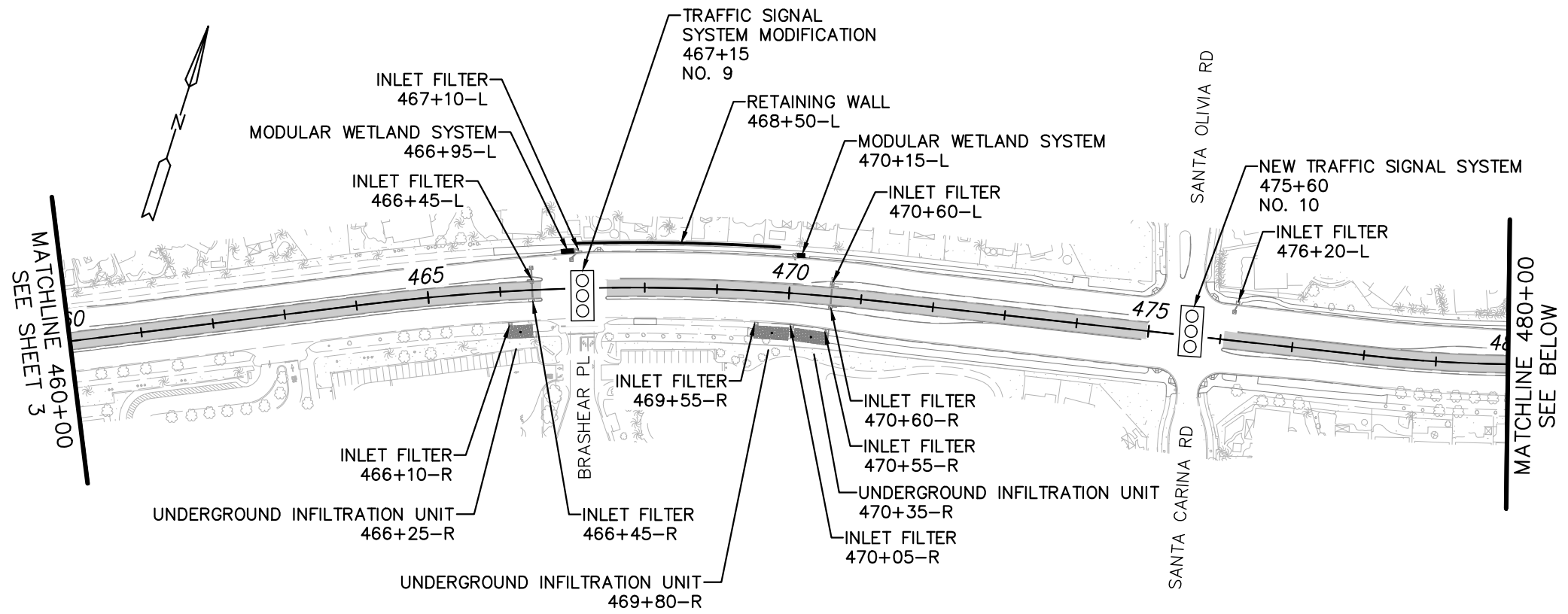

JANUARY 2019

SOUTH BAY RAPID
 MAINTENANCE AGREEMENT
 BRANDYWINE AVE TO PASEO LADERA
 SHEET 4 OF 15

Q:\CIVIL 3D\PROJECTS\ALL PROJECTS\STL399 - SOUTH BAY BRT\MAINTENANCE\SHITS\01-PH1_DAR-HERIT_KHA\SBRT-MA01-01.DWG - 1/8/2019 8:03:36 AM

Scale: 1" = 200'

Q:\CIVIL_3D\PROJECTS\ALL PROJECTS\STL399 - SOUTH BAY BRT MAINTAGREEMENT\SHITS\02-PH2_HERIT-OLY_KHA\SBBRT-MA02-01.DWG - 1/8/2019 8:04:17 AM

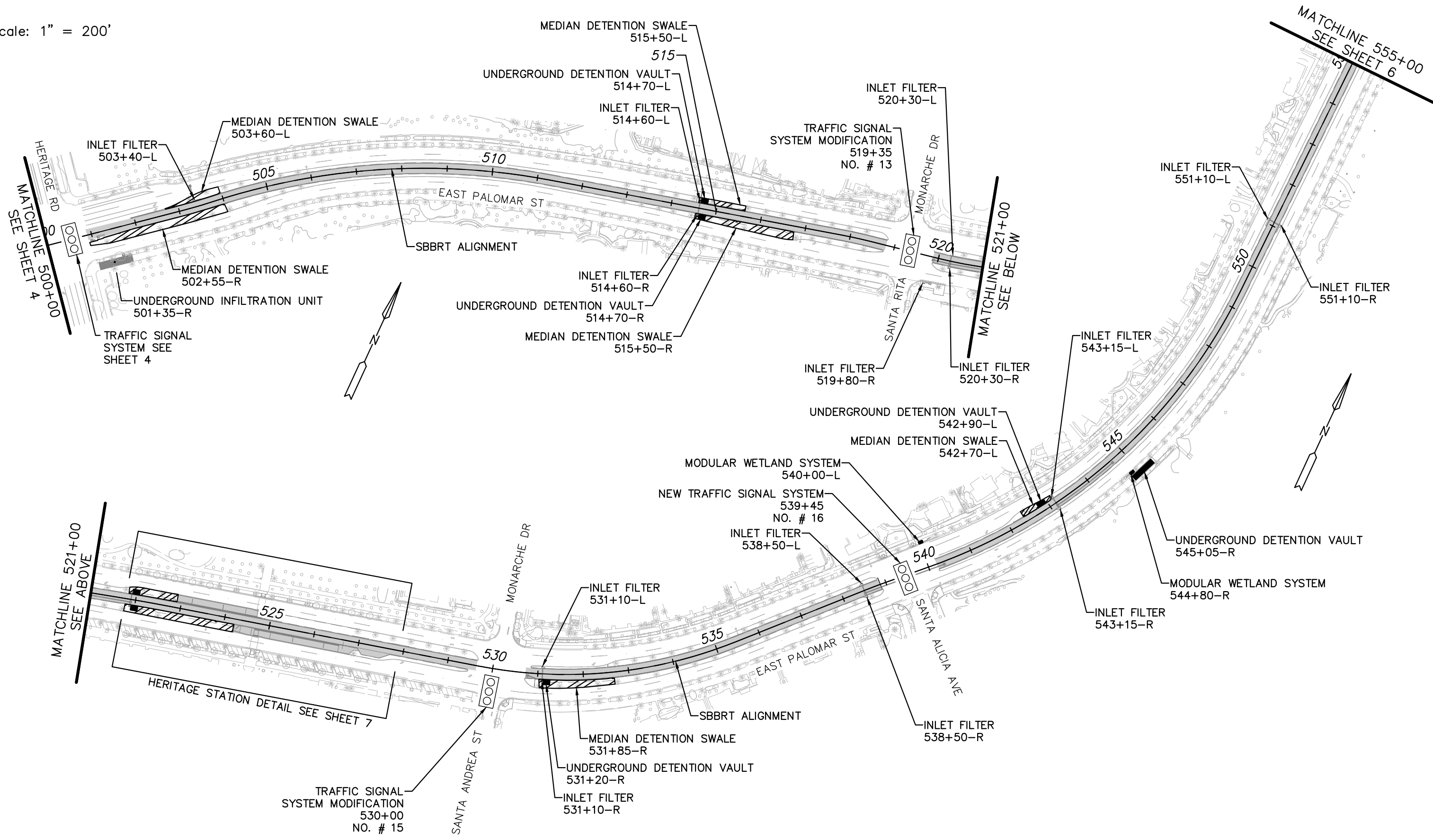

JANUARY 2019

SOUTH BAY RAPID
MAINTENANCE AGREEMENT
HERITAGE RD TO SANTA FLORA RD
SHEET 5 OF 15

Scale: 1" = 200'

Q:\CIVIL_3D\PROJECTS\ALL PROJECTS\STL399 - SOUTH BAY BRT\MAINTAGREEMENT\SHITS\02-PH2_HERIT-OLY_KHA\SBRT-MA02-01.DWG - 1/8/2019 8:04:32 AM



JANUARY 2019

SOUTH BAY RAPID
MAINTENANCE AGREEMENT
SANTA FLORA RD TO OLYMPIC PKWY
SHEET 6 OF 15

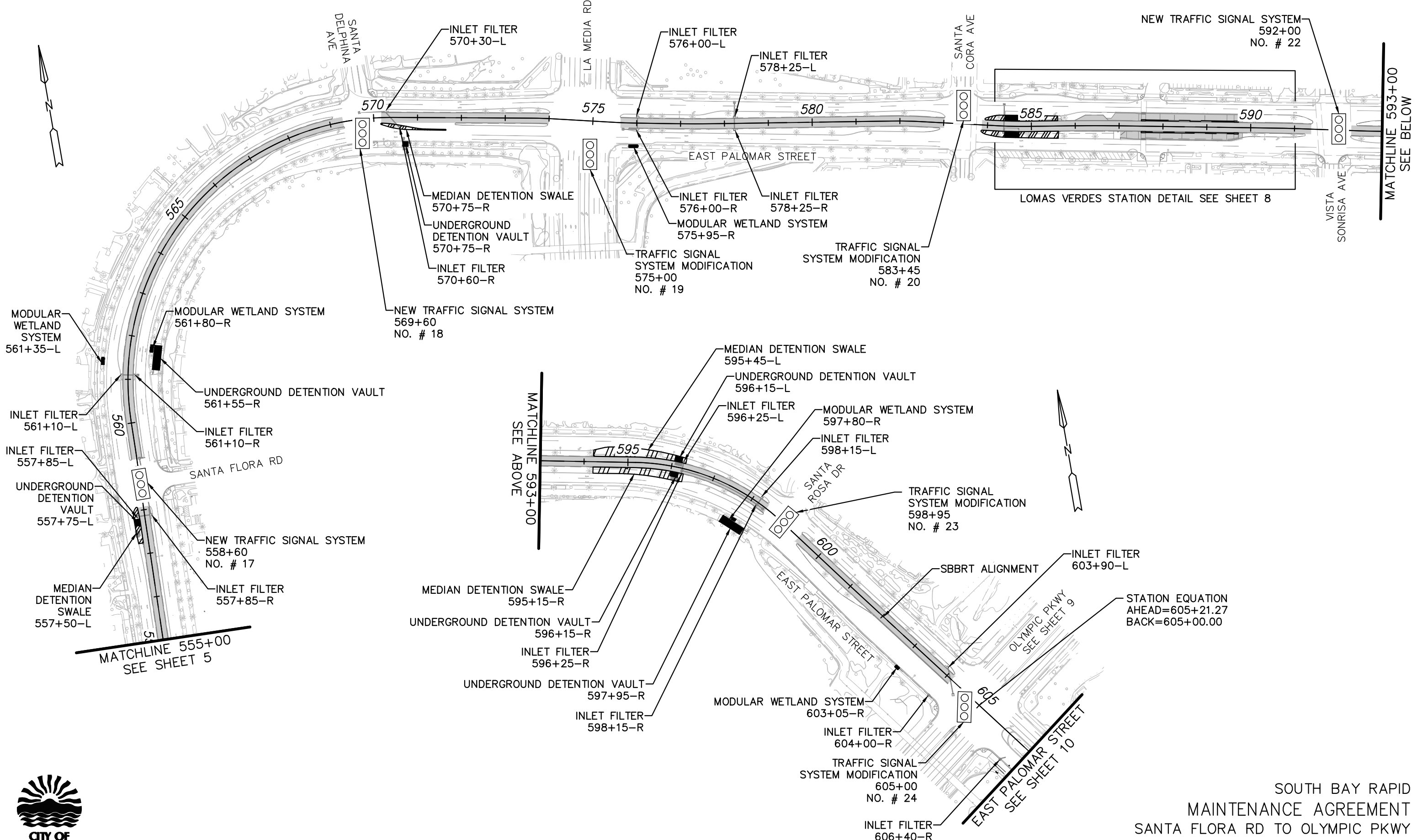

Scale: 1" = 40'

SEE SHEET 5 FOR
ADDITIONAL IMPROVEMENTS

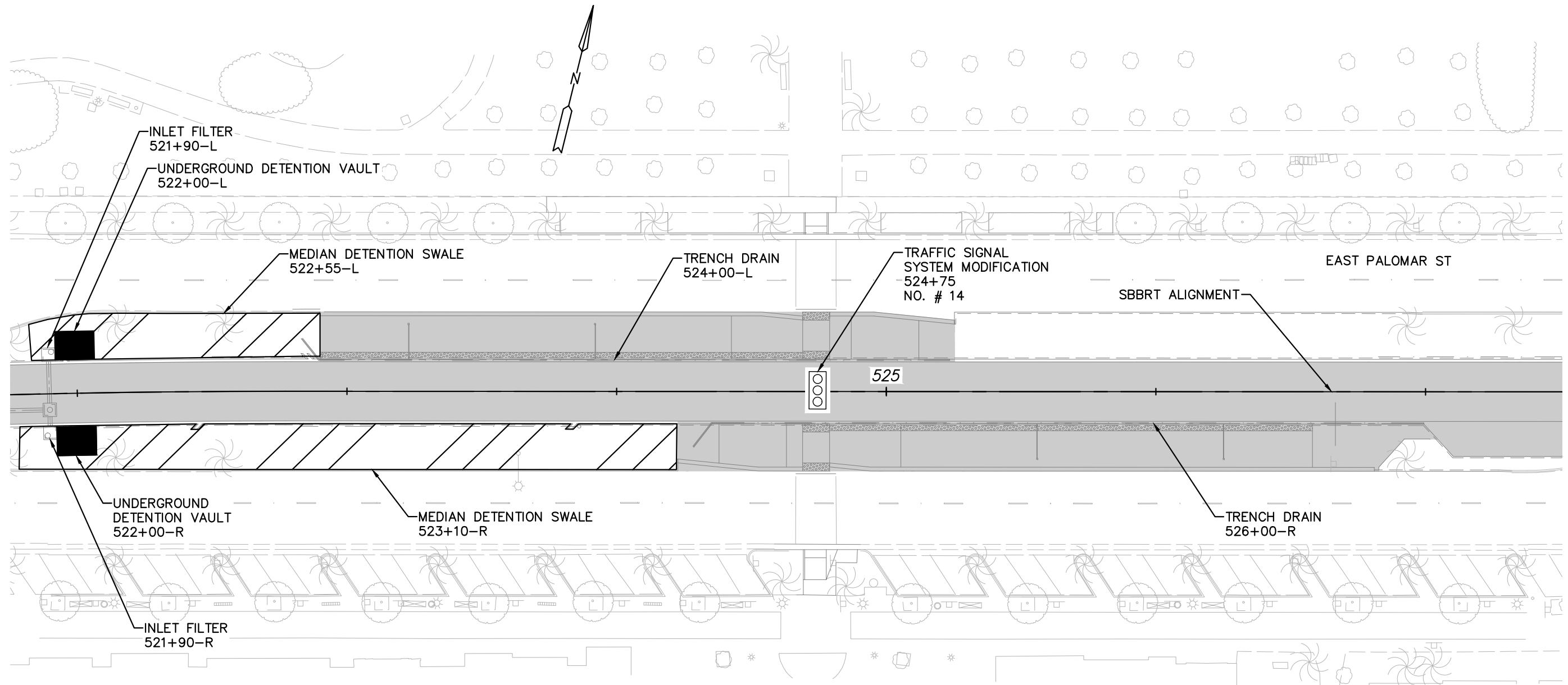

NOTE: ALL STATION AMENITIES AND APPURTENANCES INCLUDING ELECTRICAL USAGE AND WATER QUALITY MAINTENANCE ARE THE RESPONSIBILITY OF MTS.



JANUARY 2019

SOUTH BAY RAPID
MAINTENANCE AGREEMENT
HERITAGE STATION
SHEET 7 OF 15

Q:\CIVIL_3D\PROJECTS\ALL PROJECTS\STL399 - SOUTH BAY BRT\MAINTENANCE\SHITS\02-PH2_HERIT-OLY_KHA\SBBRT-MA02-01.DWG - 1/8/2019 8:04:53 AM

Scale: 1" = 60'

SEE SHEET 6 FOR
ADDITIONAL IMPROVEMENTS

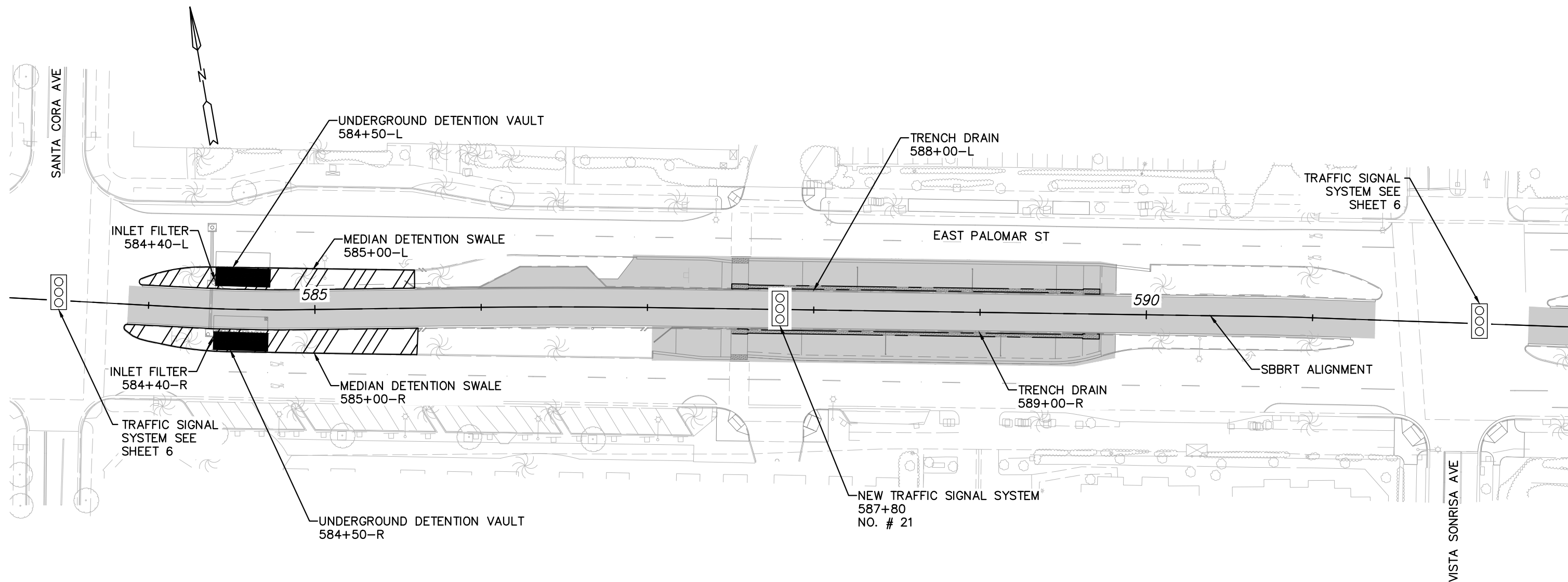

NOTE: ALL STATION AMENITIES AND APPURTENANCES INCLUDING ELECTRICAL USAGE AND WATER QUALITY MAINTENANCE ARE THE RESPONSIBILITY OF MTS.



JANUARY 2019

SOUTH BAY RAPID
MAINTENANCE AGREEMENT
LOMAS VERDES STATION
SHEET 8 OF 15

Q:\CIVIL 3D\PROJECTS\ALL PROJECTS\STL399 - SOUTH BAY BRT\MAINTAGREEMENT\SHITS\02-PH2_HERT-OLY_KHA\SBBRT-MA02-01.DWG - 1/8/2019 8:05:08 AM

Scale: 1" = 200'

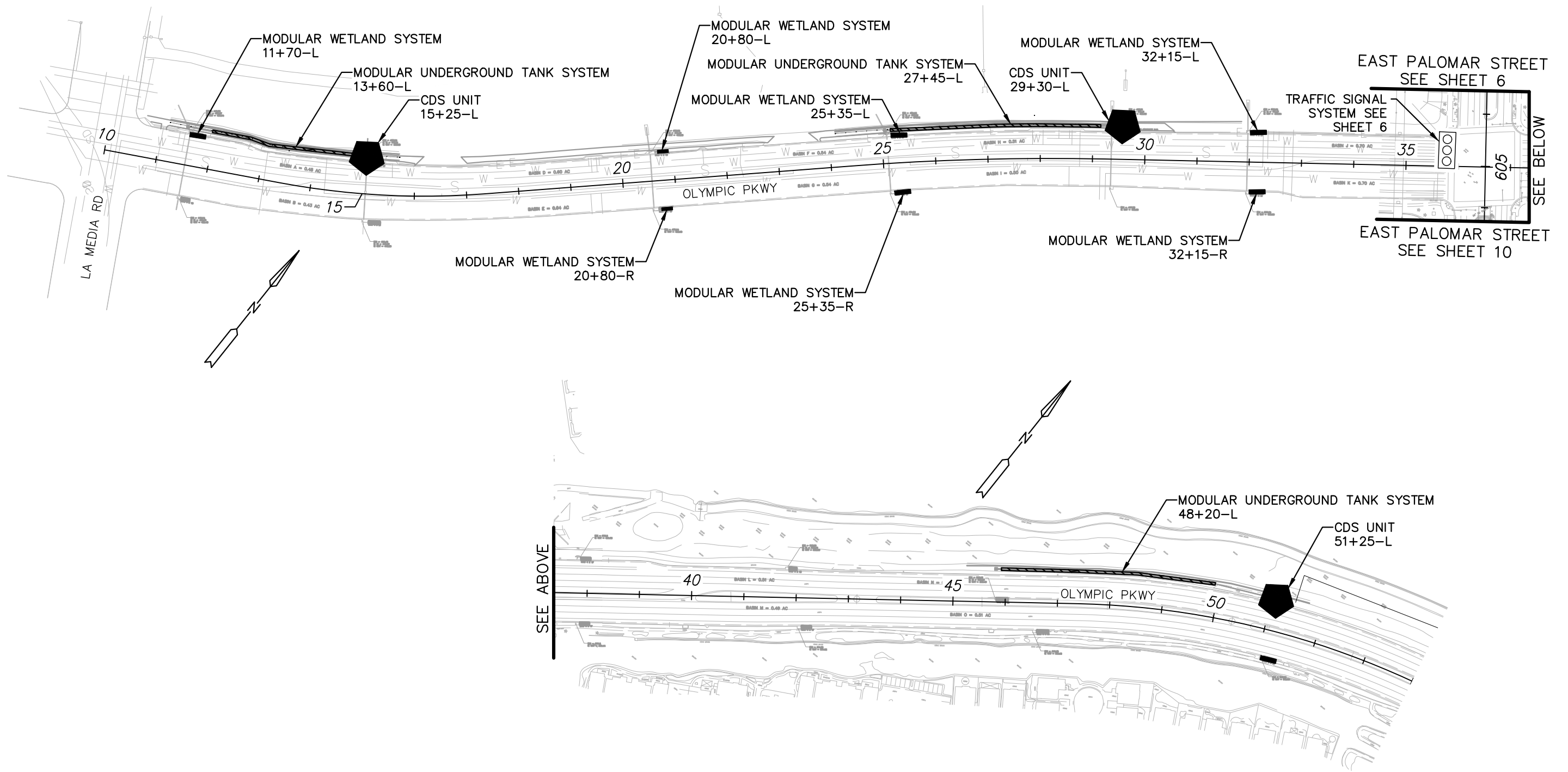

NOTE: OLYMPIC PARKWAY ALIGNMENT IS NOT A CONSTRUCTION CENTERLINE. SHOWN HERE FOR MAINTENANCE AGREEMENT PURPOSES ONLY.



JANUARY 2019

SOUTH BAY RAPID
 MAINTENANCE AGREEMENT
 OLYMPIC PARKWAY
 SHEET 9 OF 15

Q:\CIVIL 3D\PROJECTS\ALL PROJECTS\STL399 - SOUTH BAY BRT MAINTENANCE AGREEMENT\03-OLY-TWN_TYL\SBRT-MA03-01.DWG - 1/8/2019 8:06:12 AM

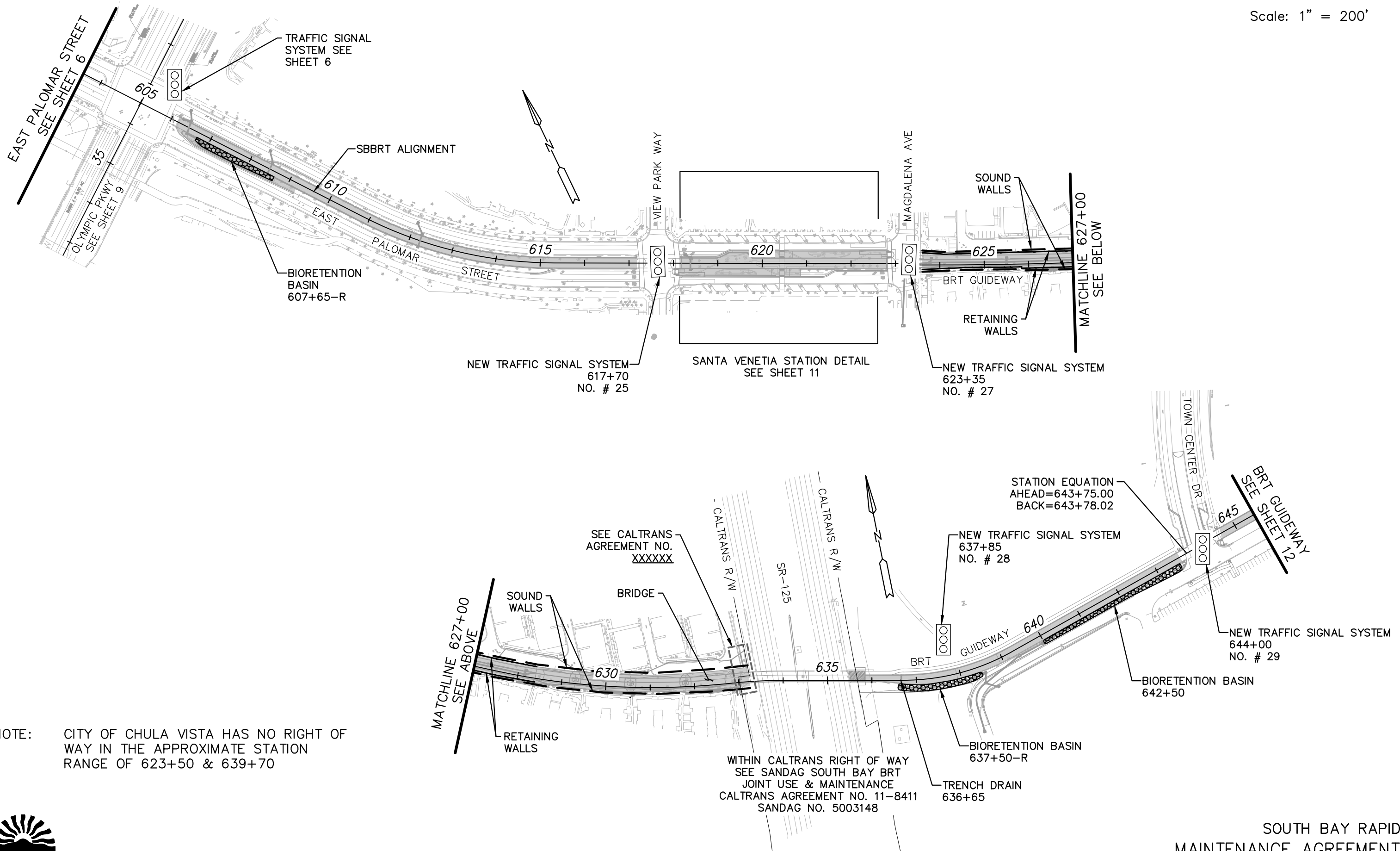

NOTE: CITY OF CHULA VISTA HAS NO RIGHT OF WAY IN THE APPROXIMATE STATION RANGE OF 623+50 & 639+70

WITHIN CALTRANS RIGHT OF WAY
SEE SANDAG SOUTH BAY BRT
JOINT USE & MAINTENANCE
CALTRANS AGREEMENT NO. 11-8411
SANDAG NO. 5003148

STATION EQUATION
AHEAD=643+75.00
BACK=643+78.02



Q:\CIVIL 3D\PROJECTS\ALL PROJECTS\STL399 - SOUTH BAY BRT\MAINTAGREEMENT\SHITS\03-OLY-TWN_TYL\SBBRT-MA03-01.DWG - 1/8/2019 8:06:28 AM

Scale: 1" = 40'

SEE SHEET 10 FOR
ADDITIONAL IMPROVEMENTS

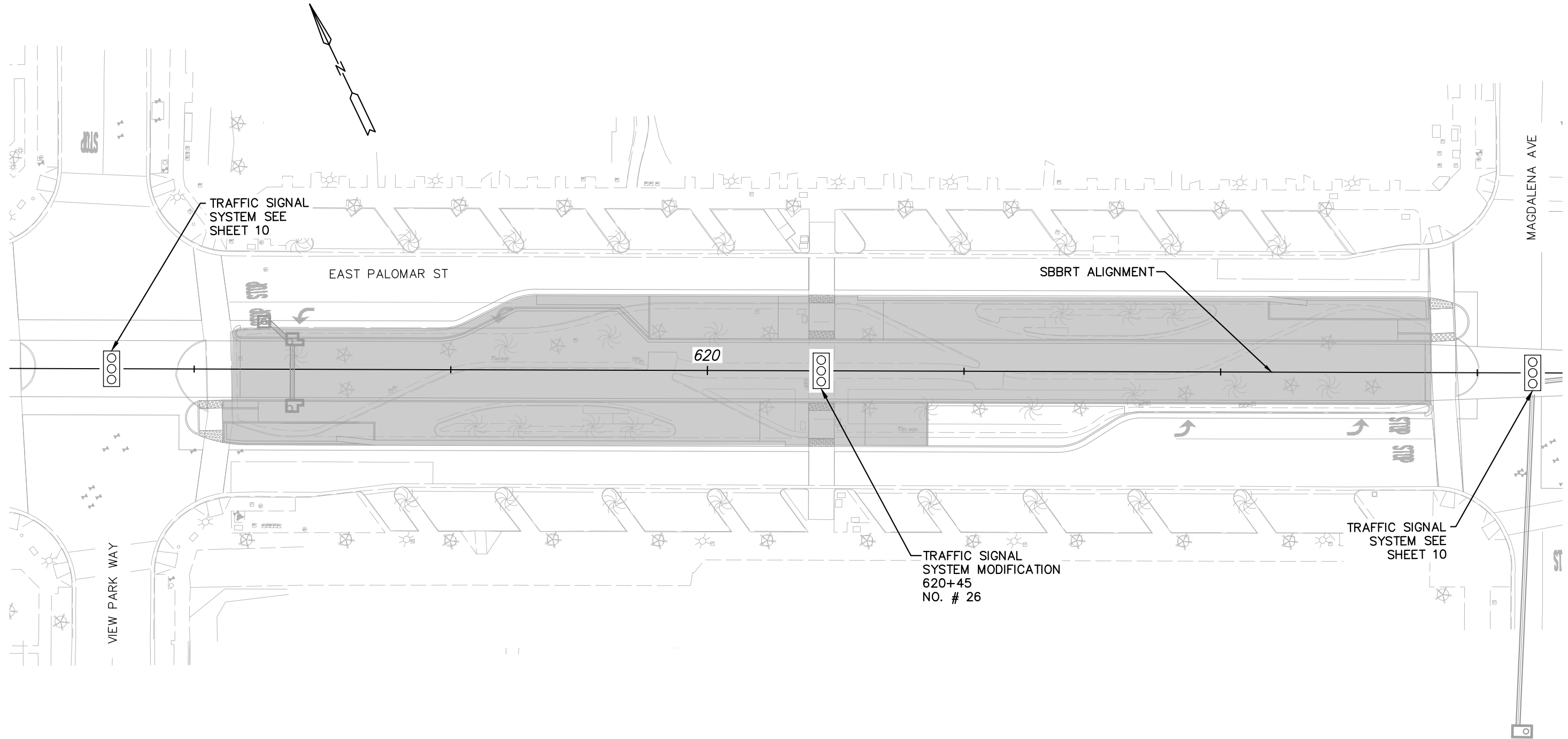

NOTE: ALL STATION AMENITIES AND APPURTENANCES INCLUDING ELECTRICAL USAGE AND WATER QUALITY MAINTENANCE ARE THE RESPONSIBILITY OF MTS.



JANUARY 2019

SOUTH BAY RAPID
MAINTENANCE AGREEMENT
SANTA VENETIA STATION DETAIL
SHEET 11 OF 15

Q:\CIVIL_3D\PROJECTS\ALL PROJECTS\STL399 - SOUTH BAY BRT\MAINTAGREEMENT\SHITS\03-OLY-TWN_TYL\SBBRT-MA03-01.DWG - 1/8/2019 8:06:37 AM

Scale: 1" = 200'

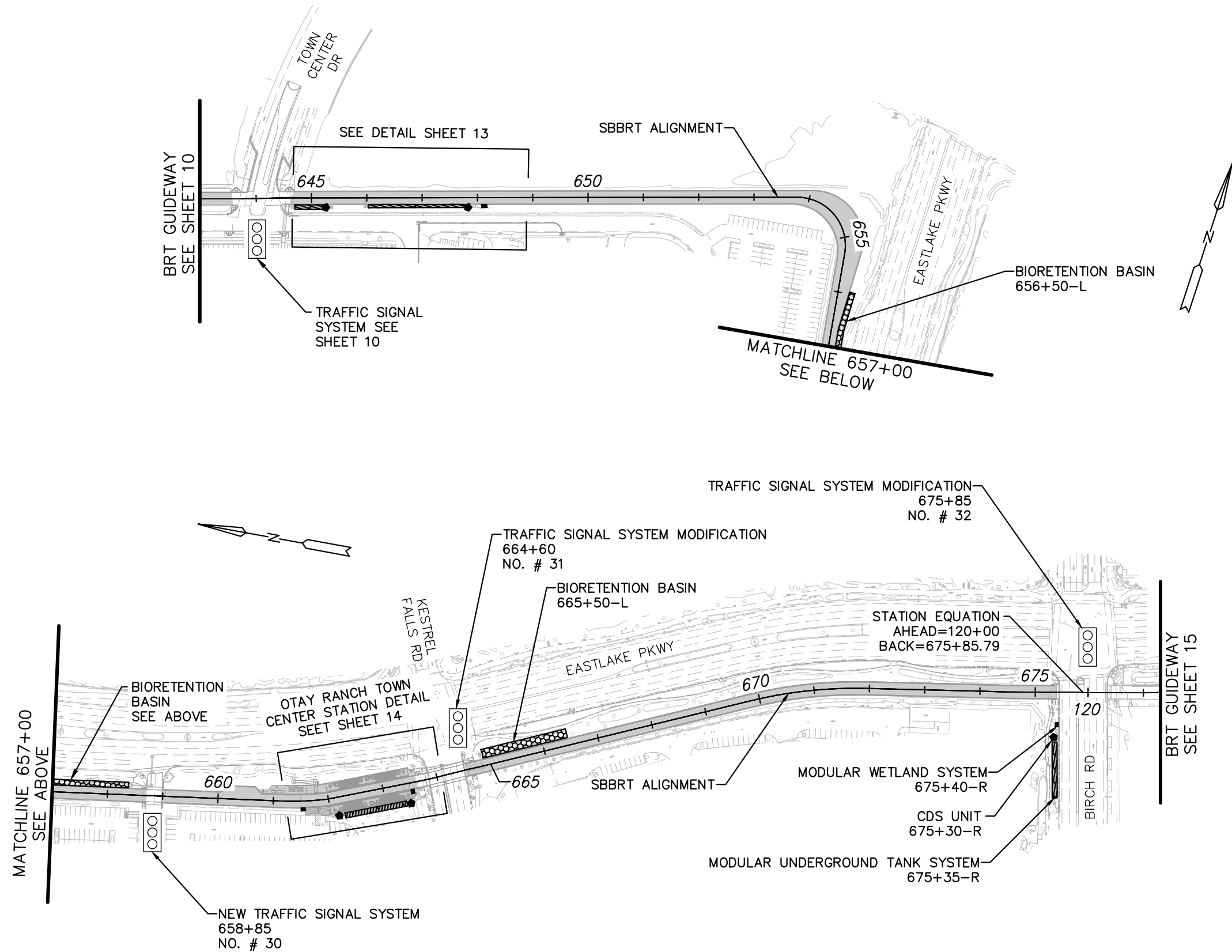

Q:\CIVIL_3D\PROJECTS\ALL PROJECTS\STL399 - SOUTH BAY BRT\MAINTAGREEMENT\SHITS\04-TWN-BRCH\CCV\SBBRT-MA04-01.DWG - 1/8/2019 8:07:33 AM



JANUARY 2019

SOUTH BAY RAPID
 MAINTENANCE AGREEMENT
 TOWN CENTER DR TO BIRCH RD
 SHEET 12 OF 15

Scale: 1" = 40'

SEE SHEET 12 FOR
ADDITIONAL IMPROVEMENTS

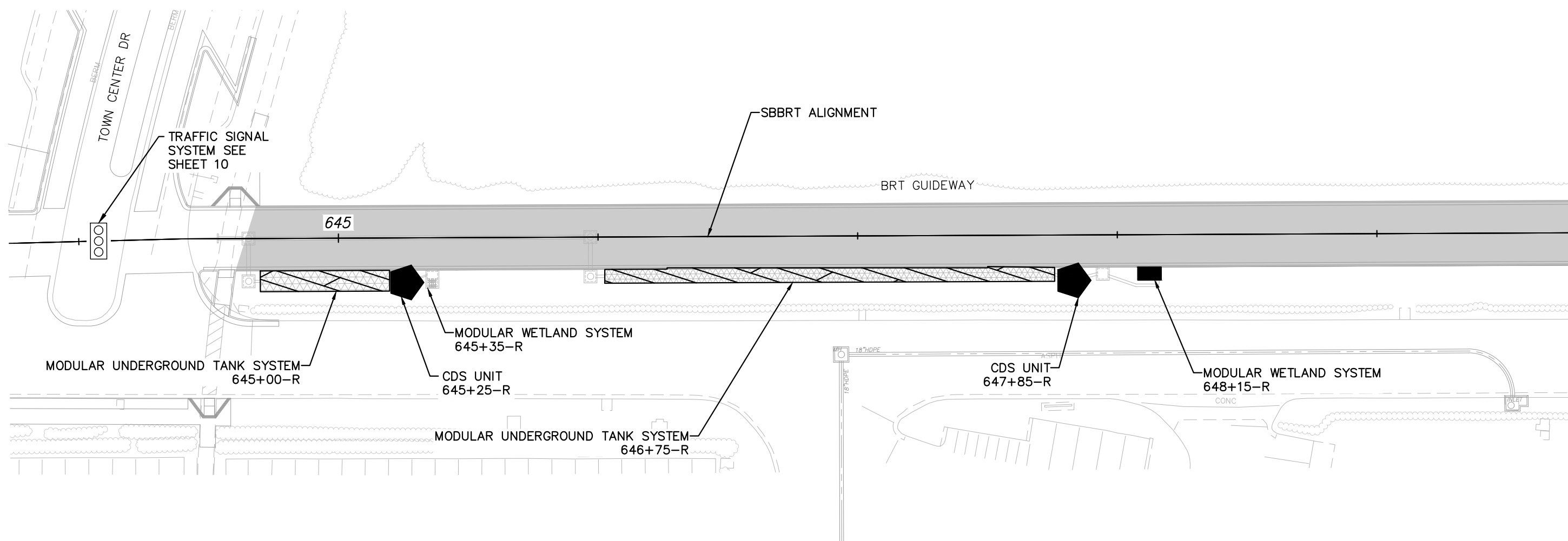

Q:\CIVIL_3D\PROJECTS\ALL PROJECTS\STL399 - SOUTH BAY BRT MAINTAGREEMENT\SHITS\04-TWN-BRCH_CCV\SBBRT-MA04-01.DWG - 1/8/2019 8:07:37 AM



JANUARY 2019

SOUTH BAY RAPID
MAINTENANCE AGREEMENT
BRT GUIDEWAY AT TOWN CENTER DR
SHEET 13 OF 15

Scale: 1" = 40'

SEE SHEET 12 FOR
ADDITIONAL IMPROVEMENTS

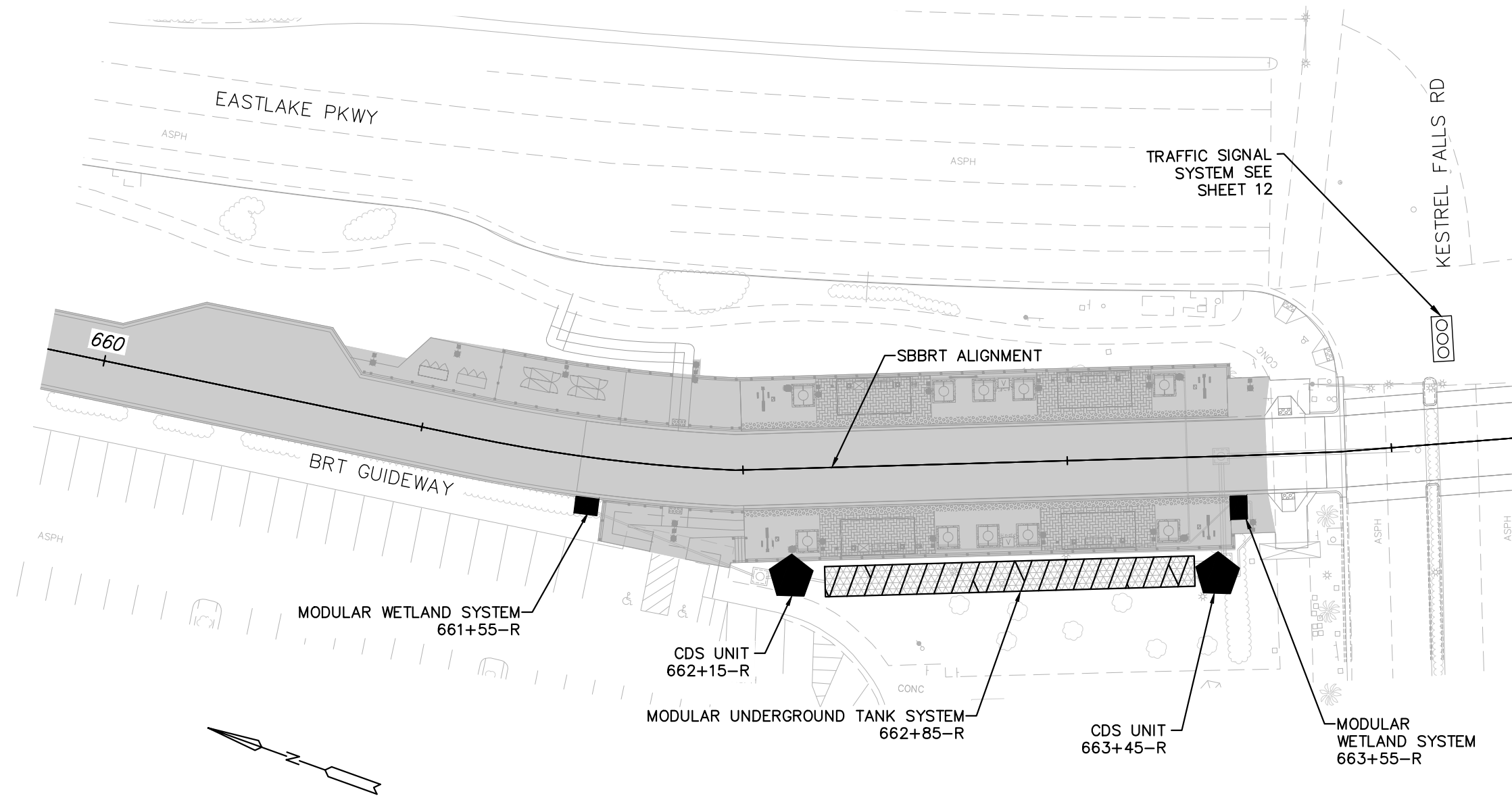

NOTE: ALL STATION AMENITIES AND APPURTENANCES INCLUDING ELECTRICAL USAGE AND WATER QUALITY MAINTENANCE ARE THE RESPONSIBILITY OF MTS.



JANUARY 2019

SOUTH BAY RAPID
MAINTENANCE AGREEMENT
OTAY RANCH PARK AND RIDE
SHEET 14 OF 15

Q:\CIVIL_3D\PROJECTS\ALL PROJECTS\STL399 - SOUTH BAY BRT\MAINTENANCE AGREEMENT\SHITS\04-TWN-BRCH_CCV_SBBRT-MA04-01.DWG - 1/8/2019 8:07:42 AM

Scale: 1" = 200'

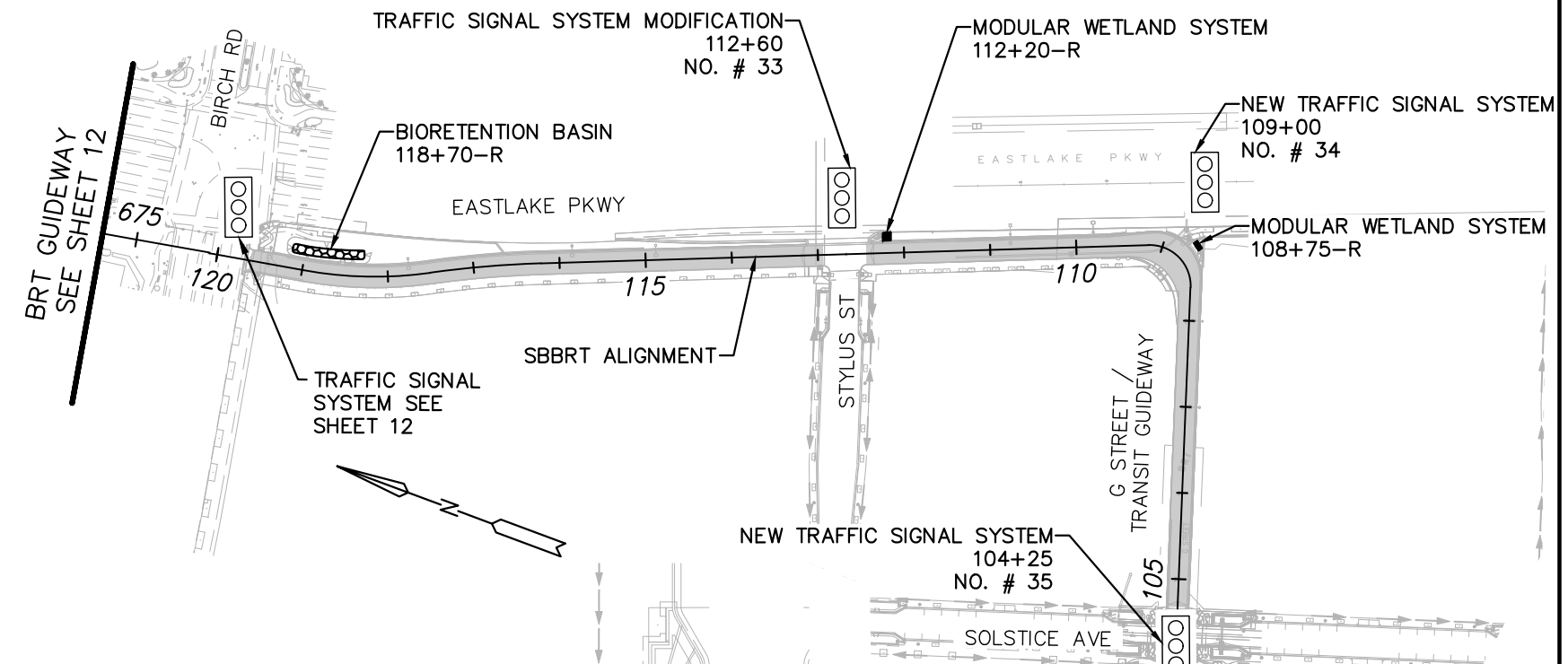

Scale: 1" = 40'

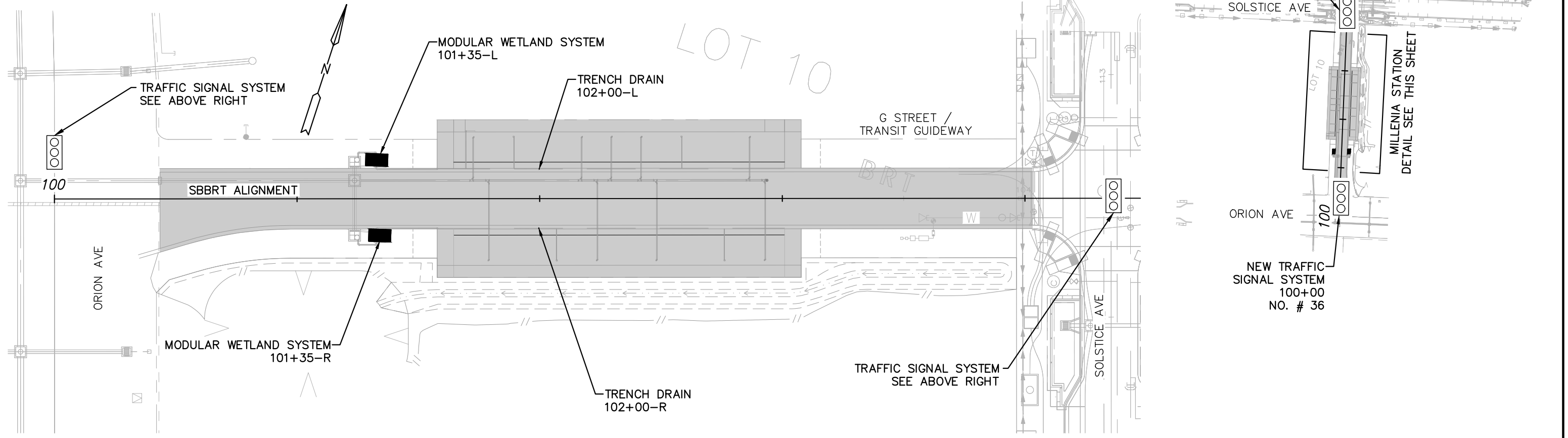

MILLENNIA STATION DETAIL

NOTE: ALL STATION AMENITIES AND APPURTENANCES INCLUDING ELECTRICAL USAGE AND WATER QUALITY MAINTENANCE ARE THE RESPONSIBILITY OF MTS.

Q:\CIVIL_3D\PROJECTS\ALL PROJECTS\STL399 - SOUTH BAY BRT\MAINTAGREEMENT\SHITS\05-BRCH-MILL_RICK\SBBRT-MA05-01.DWG - 1/8/2019 8:08:30 AM



JANUARY 2019