

FUTURE ANNEXATION AREA
COMMUNITY FACILITIES DISTRICT NO. 18M
(OTAY RANCH VILLAGE 3)
CITY OF CHULA VISTA
COUNTY OF SAN DIEGO, STATE OF CALIFORNIA

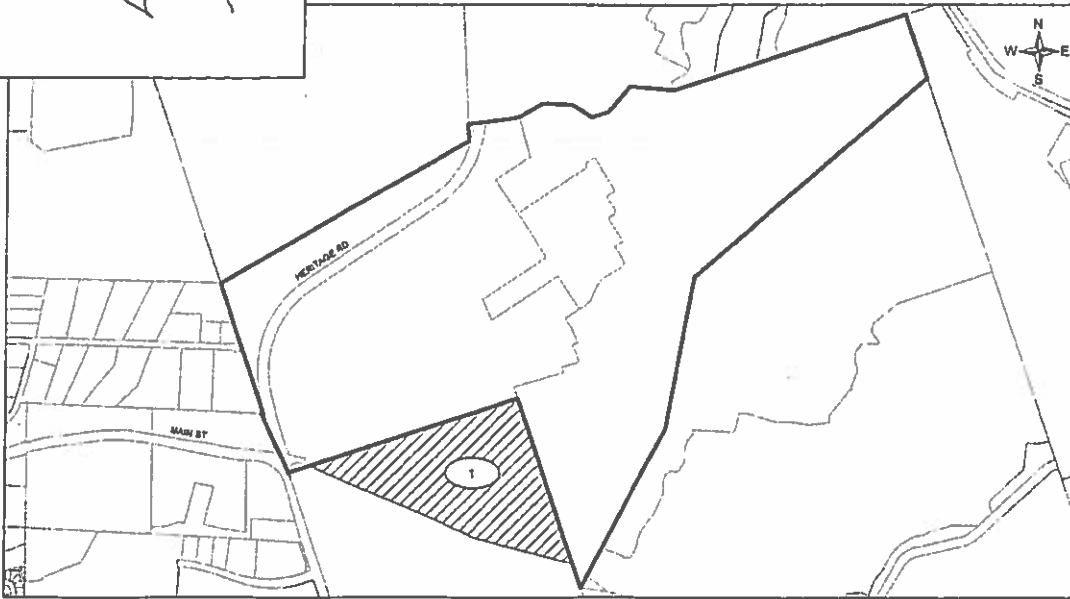

Legend

- DISTRICT BOUNDARY
- FUTURE ANNEXATION AREA

MAP REFERENCE NUMBER	ASSESSOR'S PARCEL NUMBER
1	644-060-13-00

FILED IN THE OFFICE OF THE CITY CLERK OF THE CITY OF CHULA VISTA THIS 21ST DAY OF OCTOBER, 2016.

Magdalena S. Herrera
CITY CLERK
CITY OF CHULA VISTA
STATE OF CALIFORNIA



I HEREBY CERTIFY THAT THE WITHIN MAP SHOWING PROPOSED BOUNDARIES OF THE FUTURE ANNEXATION AREA, COMMUNITY FACILITIES DISTRICT NO. 18M (OTAY RANCH VILLAGE 3) OF THE CITY OF CHULA VISTA, COUNTY OF SAN DIEGO, STATE OF CALIFORNIA, WAS APPROVED BY THE CITY COUNCIL OF THE CITY OF CHULA VISTA AT A REGULAR MEETING THEREOF HELD ON THE 21ST DAY OF OCTOBER, 2016 BY ITS RESOLUTION NO. 2016-277.

Magdalena S. Herrera
CITY CLERK
CITY OF CHULA VISTA
STATE OF CALIFORNIA



FILED THIS 11TH DAY OF OCTOBER, 2016 AT THE HOUR OF 12:30 O'CLOCK P.M. IN BOOK 416, PAGE 5 OF MAPS OF ASSESSMENT AND COMMUNITY FACILITIES DISTRICTS IN THE OFFICE OF THE COUNTY RECORDER IN THE COUNTY OF SAN DIEGO, CALIFORNIA. FILE NO. 2016-7000436

Walter J. Drepenburg, Jr.
COUNTY RECORDER
COUNTY OF SAN DIEGO
STATE OF CALIFORNIA
WALTER J. DREPENBURG, JR.

THE LINES AND DIMENSIONS OF EACH LOT OR PARCEL ENCOMPASSED BY THIS MAP SHALL BE TRUE; LINES AND DIMENSIONS AS SHOWN ON THE SAN DIEGO COUNTY ASSESSOR'S MAPS.

THE SAN DIEGO COUNTY ASSESSOR'S MAPS SHALL COVER FOR ALL DETAILS CONCERNING THE LINES AND DIMENSIONS OF SUCH LOTS OR PARCELS.

