

ATTACHMENT 2

----- INDICATES EXISTING LOT LINE PER MAP 15942

————— INDICATES PROPOSED LOT LINE

PROPERTY LINE TO BE MOVED WITHIN 1' TO 10' ON EITHER SIDE OF THE EXISTING LOT LINES AND WILL GENERALLY FOLLOW THE PROPOSED PADS.

THE AREA OF THE EXISTING IOD TO BE VACATED AND THE REPLACEMENT IOD BEING PROPOSED ON THE FINAL MAP IS 1.42 AC., MORE OR LESS

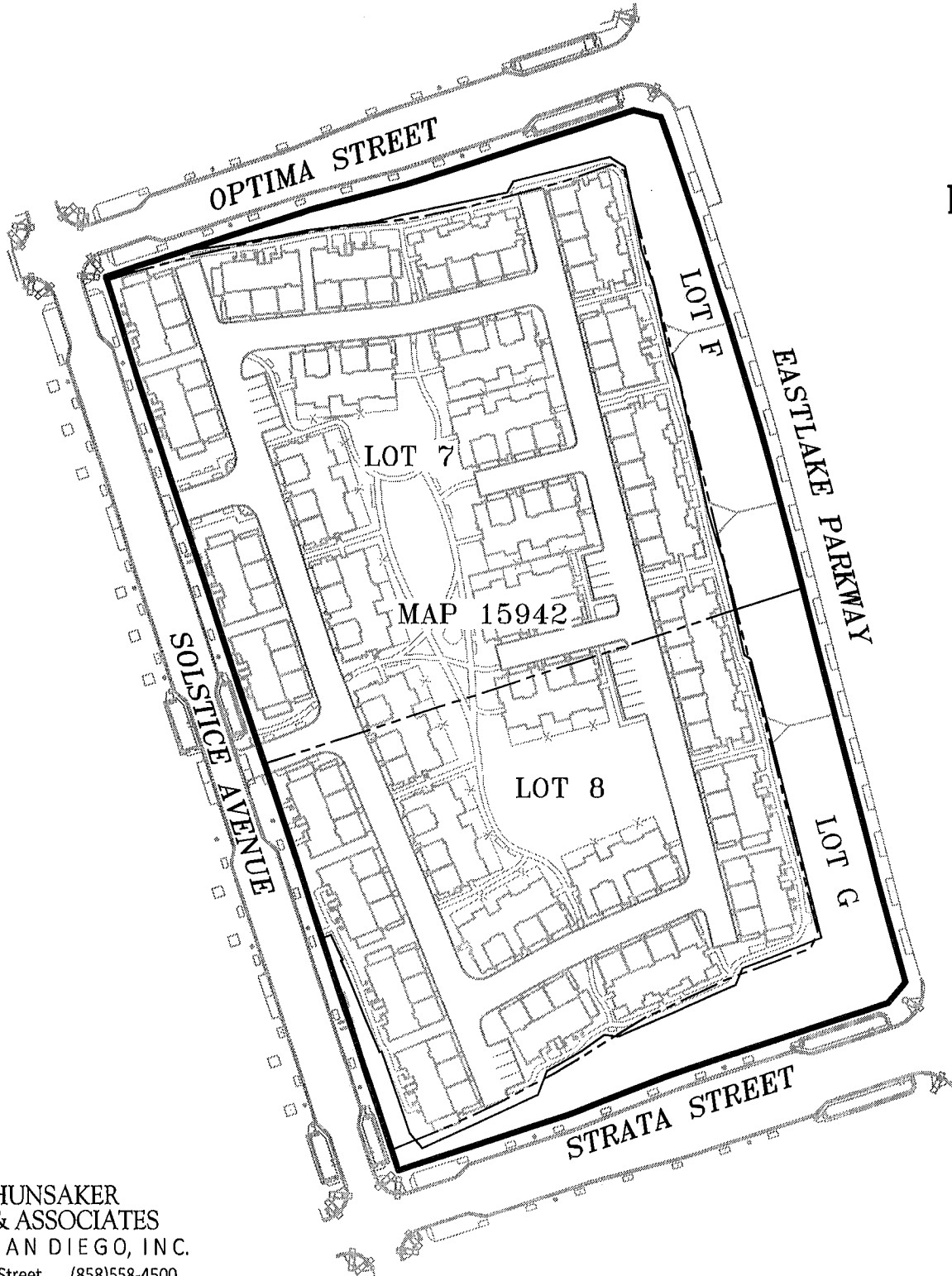

**HUNSAKER
& ASSOCIATES**
SAN DIEGO, INC.

9707 Waples Street (858)558-4500
San Diego, CA 92121