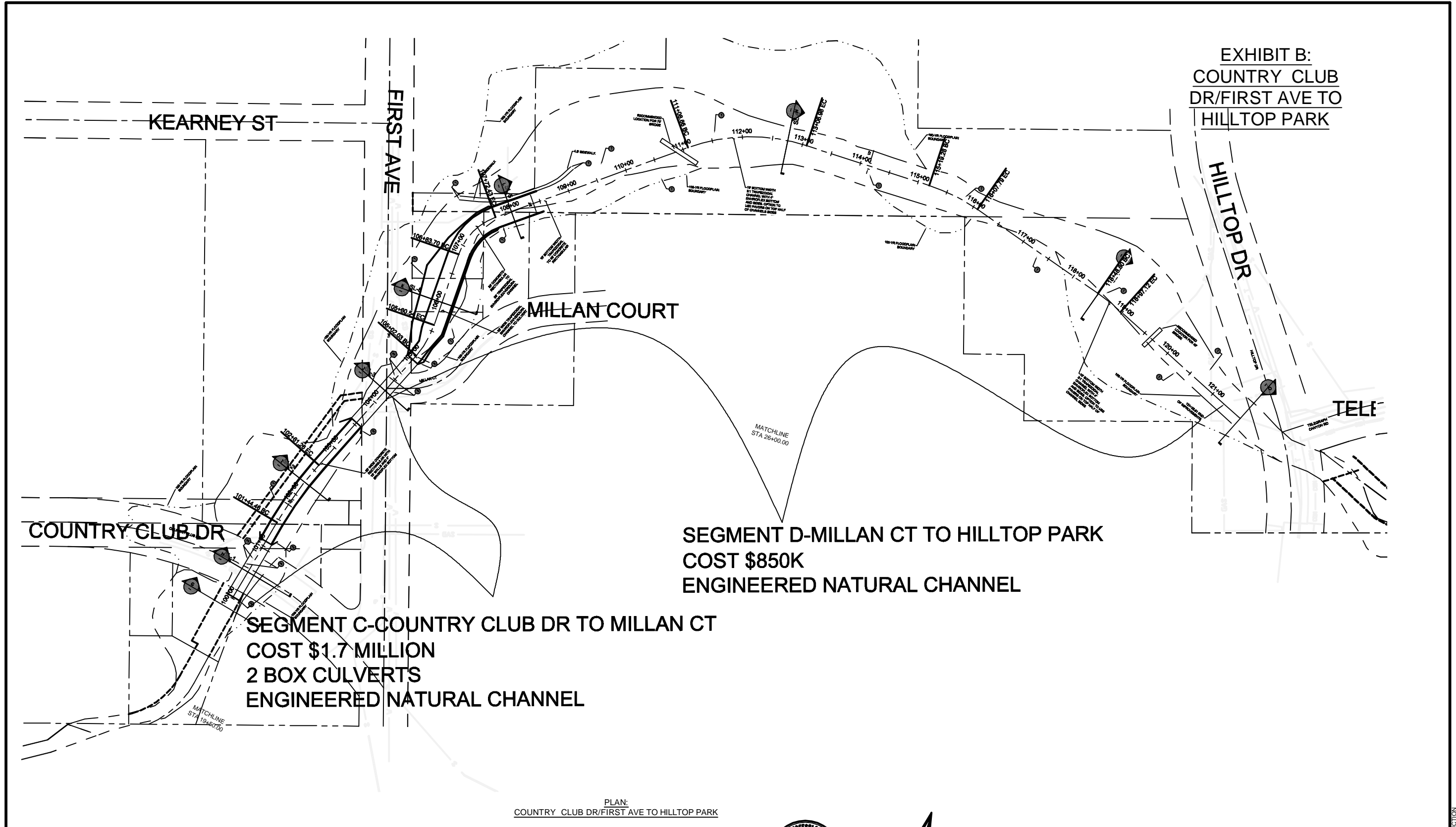

EXHIBIT B:  
COUNTRY CLUB  
DR/FIRST AVE TO  
HILLTOP PARK



SEGMENT C-COUNTRY CLUB DR TO MILLAN CT  
COST \$1.7 MILLION  
2 BOX CULVERTS  
ENGINEERED NATURAL CHANNEL

SEGMENT D-MILLAN CT TO HILLTOP PARK  
COST \$850K  
ENGINEERED NATURAL CHANNEL

PLAN:  
COUNTRY CLUB DR/FIRST AVE TO HILLTOP PARK

**AS-BUILT**

SIGNED: \_\_\_\_\_ DATE: \_\_\_\_\_  
 PRINTED NAME: \_\_\_\_\_ R.C.E. NO.: \_\_\_\_\_  
 DISCIPLINE: \_\_\_\_\_ MY REGISTRATION EXPIRATION: \_\_\_\_\_

**UTILITY NOTE**

ALL EXISTING UTILITIES SHOWN ON THESE PLANS ARE PLOTTED FROM RECORD DATA AT THEIR APPROXIMATE LOCATIONS. UNDERGROUND FACILITIES MAY EXIST WHICH HAVE NOT BEEN REPORTED OR ARE NOT OF RECORD. CONTRACTOR SHALL VERIFY THE LOCATION OF ALL PERTINENT UTILITIES IN THE FIELD PRIOR TO THE START OF CONSTRUCTION.

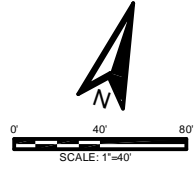

© TYPICAL SECTION - 12'X6' TRIPLE BOX CULVERT

DRAFT 30% PLANS

CONTRACTOR		NO. 57-68L, 59-103L		DATE		AUGUST 2016		RCE NO. 77724		CHECKED BY: PATRICK MONEDA, P.E., T.E. SENIOR CIVIL ENGINEER		APPROVED BY: JOSE LUIS GOMEZ, P.E., PLS. PRINCIPAL CIVIL ENGINEER		CITY OF CHULA VISTA DEPARTMENT OF PUBLIC WORKS		TELEGRAPH CANYON CHANNEL FIRST AVE/MILLAN CT/HILLTOP PARK PLAN		DRAWING NO. C-03		TOTAL SHEETS 10	
------------	--	---------------------	--	------	--	-------------	--	---------------	--	--	--	---	--	--	--	--	--	------------------	--	-----------------	--

30% SUBMITTAL - NOT FOR CONSTRUCTION