



City of Chula Vista
Community Facilities District No. 17-I
(Western Chula Vista DIF Financing Program)

CFD Report

27368 Via Industria
Suite 200
Temecula, CA 92590
T 951.587.3500 | 800.755.6864
F 951.587.3510

www.willdan.com/financial



TABLE OF CONTENTS

- I. INTRODUCTION..... 1
- II. GENERAL DESCRIPTION & BOUNDARIES OF CFD No. 17-I 2
- III. DESCRIPTION OF FACILITIES 3
- IV. COST ESTIMATES 4
- V. RATE AND METHOD OF APPORTIONMENT OF SPECIAL TAX..... 5

EXHIBIT A – BOUNDARY MAP

EXHIBIT B – FUTURE ANNEXATION AREA

EXHIBIT C – RATE AND METHOD OF APPORTIONMENT

I. Introduction

WHEREAS, the City Council of the City of Chula Vista (hereinafter referred to as the “City Council”), in the State of California, did, pursuant to the terms and provisions of Chapter 2.5 of Part 1, of Division 2, of Title 5 of the Government Code of the State of California, as amended (the “Act”), adopted a Resolution of Intention for the proposed formation of City of Chula Vista Community Facilities District No. 17-I (Western Chula Vista DIF Financing Program) (“CFD No. 17-I”).

WHEREAS, this Community Facilities District Report (“Report”) is being provided to the City Council and generally contains the following:

1. A brief description of Community Facilities District No. 17-I (Western Chula Vista DIF Financing Program) of the City of Chula Vista (“CFD NO. 17-I”);
2. A brief description of the Facilities required at the time of formation to meet the needs of CFD No. 17-I.
3. A brief description of the Boundaries of CFD 17-I; and
4. An estimate of the cost of financing the bonds used to pay for the Facilities, including all costs associated with formation of the District, issuance of bonds, determination of the amount of any special taxes, collection of any special taxes, or costs otherwise incurred in order to carry out the authorized purposes of the City with respect to the District, and any other incidental expenses to be paid through the proposed financing.

For particulars, reference is made to the Resolution of Intention, Resolution No. 6301 as previously approved. All capitalized terms not defined herein are defined in the Rate and Method of Apportionment of Special Tax section (Exhibit C) of this report.

NOW THEREFORE Willdan Financial Services, the appointed responsible firm directed to prepare the Report, pursuant to the provisions of the Code, does hereby submit the following:

II. General Description & Boundaries of CFD No. 17-I

A description of the exterior boundaries of the territory proposed for inclusion in CFD No. 17-I, including properties and parcels of land proposed to be subject to the levy of a Special Tax by CFD No. 17-I, is shown on the boundary map designated as “PROPOSED BOUNDARIES OF COMMUNITY FACILITIES DISTRICT NO. 17-I (WESTERN CHULA VISTA DIF FINANCING)”, which is on file in the office of the Clerk of the City Council of the City of Chula Vista and was recorded with the County Recorder of the County of San Diego in Book 45 of Maps of Assessment and Community Facilities Districts at page 26 and as Instrument Number 2016-7000074. A copy of the map is attached hereto as Exhibit A and hereby incorporated by reference.

A description of the exterior boundaries of the future annexation area of CFD No. 17-I, including properties and parcels of land that may use an expedited process to annex to CFD No. 17-I, is shown on the boundary map designated as “FUTURE ANNEXATION AREA COMMUNITY FACILITIES DISTRICT NO. 17-I (WESTERN CHULA VISTA DIF FINANCING)”, which is on file in the office of the Clerk of the City Council of the City of Chula Vista and was recorded with the County Recorder of the County of San Diego in Book 45 of Maps of Assessment and Community Facilities Districts at page 33 and as Instrument Number 2016-7000075. A copy of the map is attached hereto as Exhibit B and hereby incorporated by reference.

III. Description of Facilities

The General Description of the Facilities that may be acquired or constructed is as follows:

- the Public Facilities Development Impact Fee pursuant to Chula Vista Municipal Code (“CVMC”) section 3.50, et seq. (“PFDIF”);
- the Western Transportation Development Impact Fee pursuant to CVMC section 3.55, et seq. (“TDIF”);
- the Park Development Fee pursuant to CVMC section 17.10, et seq. (“PAD”);
- Certain Incidental Expenses as such term is defined in Government Code Section 53317(e) and may include, but not be limited to, all costs associated with the establishment of the District; the costs of collecting any special taxes; and
- Costs otherwise incurred in order to carry out the authorized purposes of the District

This description of the public capital facilities is general in nature. The final nature and location of improvements and facilities will be determined upon the preparation of final plans and specifications. The final plans and specifications may show substitutes in lieu of, or modifications to, proposed work. Any such substitution shall not be a change or modification in the proceedings as long as the facilities provide a service substantially similar to that as set forth in the Report.

IV. Cost Estimates

The proceeds of CFD No. 17-I will be used to fund deferred development impact fees in the estimated amount of approximately \$1,366,800. This amount may be revised at the time of Building Permit issuance to equal the exact fee amount to be deferred.

V. Rate and Method of Apportionment of Special Tax

The Rate and Method of Apportionment (RMA) provide sufficient information to allow a property owner within CFD No. 17-1 to estimate the Maximum Special Tax for his or her property. It also includes method of prepayment in full or prepayment in part and the procedure for prepayments.

For particulars on the rate and method of apportionment, reference is made to Exhibit C of this report.

EXHIBIT A

Boundary Map

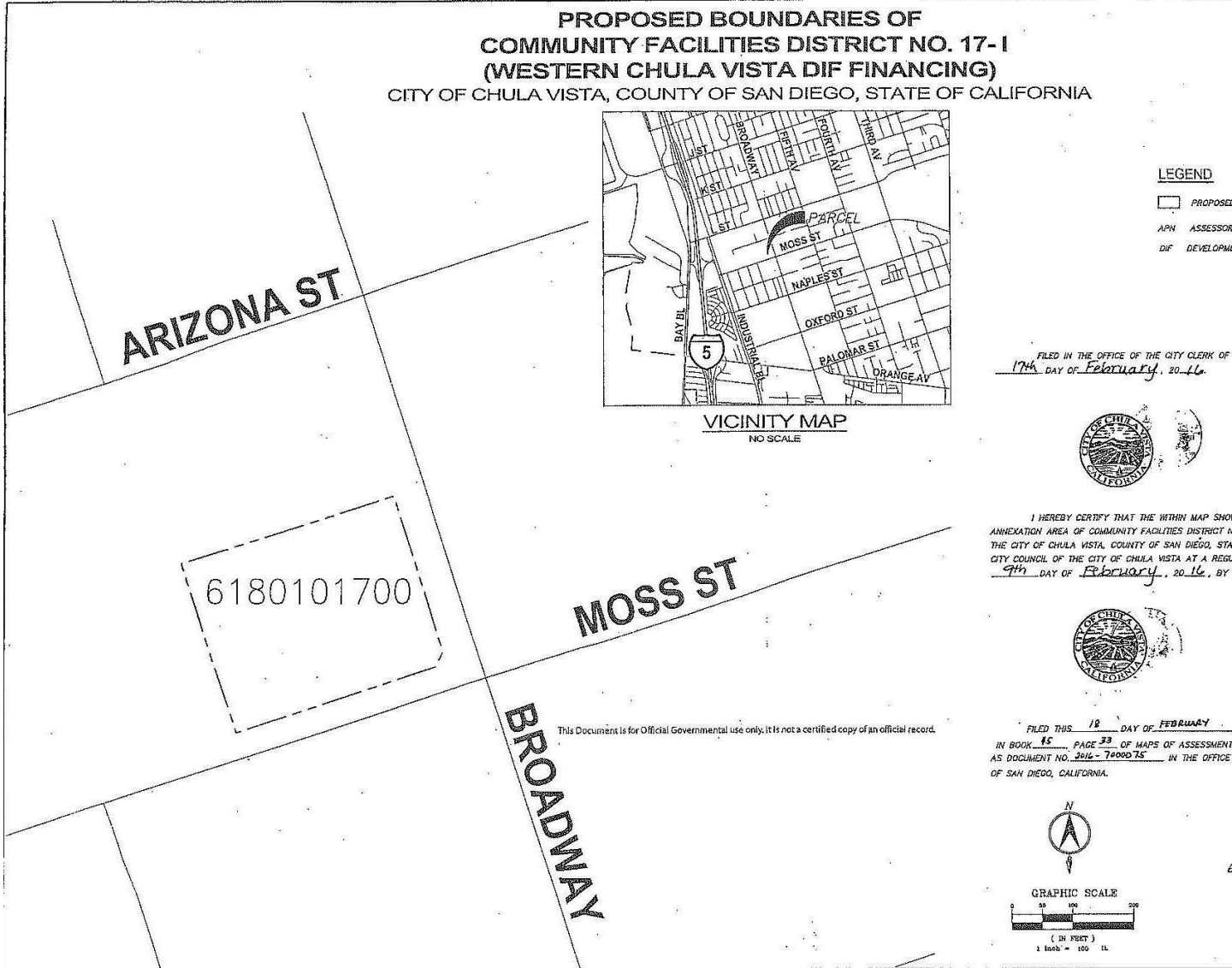

EXHIBIT B

Future Annexation Area

**FUTURE ANNEXATION AREA
COMMUNITY FACILITIES DISTRICT NO. 17-1
(WESTERN CHULA VISTA DIF FINANCING)**

SHEET 1 OF 7 SHEETS

CITY OF CHULA VISTA, COUNTY OF SAN DIEGO, STATE OF CALIFORNIA

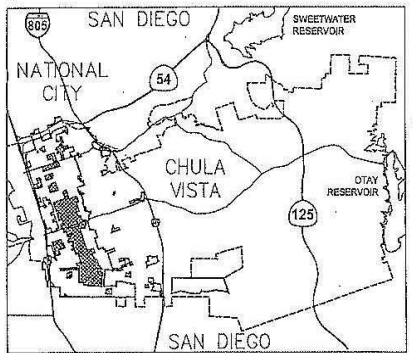

VICINITY MAP
NO SCALE

- LEGEND**
- FUTURE ANNEXATION AREA BOUNDARY
 - NOT PART OF THE FUTURE ANNEXATION AREA BOUNDARY
 - CHULA VISTA CITY LIMIT
 - APN ASSESSOR'S PARCEL NUMBER
 - DIF DEVELOPMENT IMPACT FEE

FILED IN THE OFFICE OF THE CITY CLERK OF THE CITY OF CHULA VISTA THIS
17th DAY OF February, 2016.



Alma R. Norris
CITY CLERK
CITY OF CHULA VISTA
STATE OF CALIFORNIA

I HEREBY CERTIFY THAT THE WITH MAP SHOWING PROPOSED BOUNDARIES OF THE FUTURE ANNEXATION AREA OF COMMUNITY FACILITIES DISTRICT NO. 17-1 (WEST END DIF FINANCING) OF THE CITY OF CHULA VISTA, COUNTY OF SAN DIEGO, STATE OF CALIFORNIA, WAS APPROVED BY THE CITY COUNCIL OF THE CITY OF CHULA VISTA AT A REGULAR MEETING THEREOF, HELD ON THE 9th DAY OF February, 2016, BY ITS RESOLUTION NO. 2016-019.



Alma R. Norris
CITY CLERK
CITY OF CHULA VISTA
STATE OF CALIFORNIA

FILED THIS 18 DAY OF FEBRUARY, 2016 AT THE HOUR OF 9:23 O'CLOCK A.M.
IN BOOK 45, PAGE 26 OF MAPS OF ASSESSMENT AND COMMUNITY FACILITIES DISTRICTS
AS DOCUMENT NO. 2016-7000074 IN THE OFFICE OF THE COUNTY RECORDER IN THE COUNTY
OF SAN DIEGO, CALIFORNIA.



CCarrio
COUNTY RECORDER
COUNTY OF SAN DIEGO
STATE OF CALIFORNIA
ERNEST J. DRONENBURG, JR.

QUALITY CITY MAPS, INC. 12110 City of Chula Vista, CA 92015-12110. All Rights Reserved. 12/15/10. 1000000

BK 45 PG 26

2016-7000074

2016-7000074

BK 45 PG 26

FUTURE ANNEXATION AREA
COMMUNITY FACILITIES DISTRICT NO. 17 - I
(WESTERN CHULA VISTA DIF FINANCING)
CITY OF CHULA VISTA, COUNTY OF SAN DIEGO, STATE OF CALIFORNIA

SHEET 3 OF 7 SHEETS

2016-7000074
BK45 PG28

567080200	567140200	567200200	567260200	567320200	567380200	567440200	567500200	567560200	567620200	567680200	567740200	567800200	567860200	567920200	567980200	568040200	568100200	568160200	568220200	568280200	568340200	568400200	568460200	568520200	568580200	568640200	568700200	568760200	568820200	568880200	568940200	569000200	569060200	569120200	569180200	569240200	569300200	569360200	569420200	569480200	569540200	569600200	569660200	569720200	569780200	569840200	569900200	569960200	570020200	570080200	570140200	570200200	570260200	570320200	570380200	570440200	570500200	570560200	570620200	570680200	570740200	570800200	570860200	570920200	570980200	571040200	571100200	571160200	571220200	571280200	571340200	571400200	571460200	571520200	571580200	571640200	571700200	571760200	571820200	571880200	571940200	572000200	572060200	572120200	572180200	572240200	572300200	572360200	572420200	572480200	572540200	572600200	572660200	572720200	572780200	572840200	572900200	572960200	573020200	573080200	573140200	573200200	573260200	573320200	573380200	573440200	573500200	573560200	573620200	573680200	573740200	573800200	573860200	573920200	573980200	574040200	574100200	574160200	574220200	574280200	574340200	574400200	574460200	574520200	574580200	574640200	574700200	574760200	574820200	574880200	574940200	575000200	575060200	575120200	575180200	575240200	575300200	575360200	575420200	575480200	575540200	575600200	575660200	575720200	575780200	575840200	575900200	575960200	576020200	576080200	576140200	576200200	576260200	576320200	576380200	576440200	576500200	576560200	576620200	576680200	576740200	576800200	576860200	576920200	576980200	577040200	577100200	577160200	577220200	577280200	577340200	577400200	577460200	577520200	577580200	577640200	577700200	577760200	577820200	577880200	577940200	578000200	578060200	578120200	578180200	578240200	578300200	578360200	578420200	578480200	578540200	578600200	578660200	578720200	578780200	578840200	578900200	578960200	579020200	579080200	579140200	579200200	579260200	579320200	579380200	579440200	579500200	579560200	579620200	579680200	579740200	579800200	579860200	579920200	579980200	580040200	580100200	580160200	580220200	580280200	580340200	580400200	580460200	580520200	580580200	580640200	580700200	580760200	580820200	580880200	580940200	581000200	581060200	581120200	581180200	581240200	581300200	581360200	581420200	581480200	581540200	581600200	581660200	581720200	581780200	581840200	581900200	581960200	582020200	582080200	582140200	582200200	582260200	582320200	582380200	582440200	582500200	582560200	582620200	582680200	582740200	582800200	582860200	582920200	582980200	583040200	583100200	583160200	583220200	583280200	583340200	583400200	583460200	583520200	583580200	583640200	583700200	583760200	583820200	583880200	583940200	584000200	584060200	584120200	584180200	584240200	584300200	584360200	584420200	584480200	584540200	584600200	584660200	584720200	584780200	584840200	584900200	584960200	585020200	585080200	585140200	585200200	585260200	585320200	585380200	585440200	585500200	585560200	585620200	585680200	585740200	585800200	585860200	585920200	585980200	586040200	586100200	586160200	586220200	586280200	586340200	586400200	586460200	586520200	586580200	586640200	586700200	586760200	586820200	586880200	586940200	587000200	587060200	587120200	587180200	587240200	587300200	587360200	587420200	587480200	587540200	587600200	587660200	587720200	587780200	587840200	587900200	587960200	588020200	588080200	588140200	588200200	588260200	588320200	588380200	588440200	588500200	588560200	588620200	588680200	588740200	588800200	588860200	588920200	588980200	589040200	589100200	589160200	589220200	589280200	589340200	589400200	589460200	589520200	589580200	589640200	589700200	589760200	589820200	589880200	589940200	590000200	590060200	590120200	590180200	590240200	590300200	590360200	590420200	590480200	590540200	590600200	590660200	590720200	590780200	590840200	590900200	590960200	591020200	591080200	591140200	591200200	591260200	591320200	591380200	591440200	591500200	591560200	591620200	591680200	591740200	591800200	591860200	591920200	591980200	592040200	592100200	592160200	592220200	592280200	592340200	592400200	592460200	592520200	592580200	592640200	592700200	592760200	592820200	592880200	592940200	593000200	593060200	593120200	593180200	593240200	593300200	593360200	593420200	593480200	593540200	593600200	593660200	593720200	593780200	593840200	593900200	593960200	594020200	594080200	594140200	594200200	594260200	594320200	594380200	594440200	594500200	594560200	594620200	594680200	594740200	594800200	594860200	594920200	594980200	595040200	595100200	595160200	595220200	595280200	595340200	595400200	595460200	595520200	595580200	595640200	595700200	595760200	595820200	595880200	595940200	596000200	596060200	596120200	596180200	596240200	596300200	596360200	596420200	596480200	596540200	596600200	596660200	596720200	596780200	596840200	596900200	596960200	597020200	597080200	597140200	597200200	597260200	597320200	597380200	597440200	597500200	597560200	597620200	597680200	597740200	597800200	597860200	597920200	597980200	598040200	598100200	598160200	598220200	598280200	598340200	598400200	598460200	598520200	598580200	598640200	598700200	598760200	598820200	598880200	598940200	599000200	599060200	599120200	599180200	599240200	599300200	599360200	599420200	599480200	599540200	599600200	599660200	599720200	599780200	599840200	599900200	599960200	600020200	600080200	600140200	600200200	600260200	600320200	600380200	600440200	600500200	600560200	600620200	600680200	600740200	600800200	600860200	600920200	600980200	601040200	601100200	601160200	601220200	601280200	601340200	601400200	601460200	601520200	601580200	601640200	601700200	601760200	601820200	601880200	601940200	602000200	602060200	602120200	602180200	602240200	602300200	602360200	602420200	602480200	602540200	602600200	602660200	602720200	602780200	602840200	602900200	602960200	603020200	603080200	603140200	603200200	603260200	603320200	603380200	603440200	603500200	603560200	603620200	603680200	603740200	603800200	603860200	603920200	603980200	604040200	604100200	604160200	604220200	604280200	604340200	604400200	604460200	604520200	604580200	604640200	604700200	604760200	604820200	604880200	604940200	605000200	605060200	605120200	605180200	605240200	605300200	605360200	605420200	605480200	605540200	605600200	605660200	605720200	605780200	605840200	605900200	605960200	606020200	606080200	606140200	606200200	606260200	606320200	606380200	606440200	606500200	606560200	606620200	606680200	606740200	606800200	606860200	606920200	606980200	607040200	607100200	607160200	607220200	607280200	607340200	607400200	607460200	607520200	607580200	607640200	607700200	607760200	607820200	607880200	607940200	608000200	608060200	608120200	608180200	608240200	608300200	608360200	608420200	608480200	608540200	608600200	608660200	608720200	608780200	608840200	608900200	608960200	609020200	609080200	609140200	609200200	609260200	609320200	609380200	609440200	609500200	609560200	609620200	609680200	609740200	609800200	609860200	609920200	609980200	610040200	610100200	610160200	610220200	610280200	610340200	610400200	610460200	610520200	610580200	610640200	610700200	610760200	610820200	610880200	610940200	611000200	611060200	611120200	611180200	611240200	611300200	611360200	611420200	611480200	611540200	611600200	611660200	611720200	611780200	611840200	611900200	611960200	612020200	612080200	612140200	612200200	612260200	612320200	612380200	612440200	612500200	612560200	612620200	612680200	612740200	612800200	612860200	612920200	612980200	613040200	613100200	613160200	613220200	613280200	613340200	613400200	613460200	613520200	613580200	613640200	613700200	613760200	613820200	613880200	613940200	614000200	614060200	614120200	614180200	614240200	614300200	614360200	614420200	614480200	614540200	614600200	614660200	614720200	614780200	614840200	614900200	614960200	615020200	615080200	615140200	615200200	615260200	615320200	615380200	615440200	615500200	615560200	615620200	615680200	615740200	615800200	615860200	615920200	615980200	616040200	616100200	616160200	616220200	616280200	616340200	616400200	616460200	616520200	616580200	616640200	616700200	616760200	616820200	616880200	616940200	617000200	617060200	617120200	617180200	617240200	617300200	617360200	617420200	617480200	617540200	617600200	617660200	617720200	617780200	617840200	617900200	617960200	618020200	618080200	618140200	618200200	618260200	618320200	618380200	618440200	618500200	618560200	618620200	618680200	618740200	618800200	618860200
-----------	-----------	-----------	-----------	-----------	-----------	-----------	-----------	-----------	-----------	-----------	-----------	-----------	-----------	-----------	-----------	-----------	-----------	-----------	-----------	-----------	-----------	-----------	-----------	-----------	-----------	-----------	-----------	-----------	-----------	-----------	-----------	-----------	-----------	-----------	-----------	-----------	-----------	-----------	-----------	-----------	-----------	-----------	-----------	-----------	-----------	-----------	-----------	-----------	-----------	-----------	-----------	-----------	-----------	-----------	-----------	-----------	-----------	-----------	-----------	-----------	-----------	-----------	-----------	-----------	-----------	-----------	-----------	-----------	-----------	-----------	-----------	-----------	-----------	-----------	-----------	-----------	-----------	-----------	-----------	-----------	-----------	-----------	-----------	-----------	-----------	-----------	-----------	-----------	-----------	-----------	-----------	-----------	-----------	-----------	-----------	-----------	-----------	-----------	-----------	-----------	-----------	-----------	-----------	-----------	-----------	-----------	-----------	-----------	-----------	-----------	-----------	-----------	-----------	-----------	-----------	-----------	-----------	-----------	-----------	-----------	-----------	-----------	-----------	-----------	-----------	-----------	-----------	-----------	-----------	-----------	-----------	-----------	-----------	-----------	-----------	-----------	-----------	-----------	-----------	-----------	-----------	-----------	-----------	-----------	-----------	-----------	-----------	-----------	-----------	-----------	-----------	-----------	-----------	-----------	-----------	-----------	-----------	-----------	-----------	-----------	-----------	-----------	-----------	-----------	-----------	-----------	-----------	-----------	-----------	-----------	-----------	-----------	-----------	-----------	-----------	-----------	-----------	-----------	-----------	-----------	-----------	-----------	-----------	-----------	-----------	-----------	-----------	-----------	-----------	-----------	-----------	-----------	-----------	-----------	-----------	-----------	-----------	-----------	-----------	-----------	-----------	-----------	-----------	-----------	-----------	-----------	-----------	-----------	-----------	-----------	-----------	-----------	-----------	-----------	-----------	-----------	-----------	-----------	-----------	-----------	-----------	-----------	-----------	-----------	-----------	-----------	-----------	-----------	-----------	-----------	-----------	-----------	-----------	-----------	-----------	-----------	-----------	-----------	-----------	-----------	-----------	-----------	-----------	-----------	-----------	-----------	-----------	-----------	-----------	-----------	-----------	-----------	-----------	-----------	-----------	-----------	-----------	-----------	-----------	-----------	-----------	-----------	-----------	-----------	-----------	-----------	-----------	-----------	-----------	-----------	-----------	-----------	-----------	-----------	-----------	-----------	-----------	-----------	-----------	-----------	-----------	-----------	-----------	-----------	-----------	-----------	-----------	-----------	-----------	-----------	-----------	-----------	-----------	-----------	-----------	-----------	-----------	-----------	-----------	-----------	-----------	-----------	-----------	-----------	-----------	-----------	-----------	-----------	-----------	-----------	-----------	-----------	-----------	-----------	-----------	-----------	-----------	-----------	-----------	-----------	-----------	-----------	-----------	-----------	-----------	-----------	-----------	-----------	-----------	-----------	-----------	-----------	-----------	-----------	-----------	-----------	-----------	-----------	-----------	-----------	-----------	-----------	-----------	-----------	-----------	-----------	-----------	-----------	-----------	-----------	-----------	-----------	-----------	-----------	-----------	-----------	-----------	-----------	-----------	-----------	-----------	-----------	-----------	-----------	-----------	-----------	-----------	-----------	-----------	-----------	-----------	-----------	-----------	-----------	-----------	-----------	-----------	-----------	-----------	-----------	-----------	-----------	-----------	-----------	-----------	-----------	-----------	-----------	-----------	-----------	-----------	-----------	-----------	-----------	-----------	-----------	-----------	-----------	-----------	-----------	-----------	-----------	-----------	-----------	-----------	-----------	-----------	-----------	-----------	-----------	-----------	-----------	-----------	-----------	-----------	-----------	-----------	-----------	-----------	-----------	-----------	-----------	-----------	-----------	-----------	-----------	-----------	-----------	-----------	-----------	-----------	-----------	-----------	-----------	-----------	-----------	-----------	-----------	-----------	-----------	-----------	-----------	-----------	-----------	-----------	-----------	-----------	-----------	-----------	-----------	-----------	-----------	-----------	-----------	-----------	-----------	-----------	-----------	-----------	-----------	-----------	-----------	-----------	-----------	-----------	-----------	-----------	-----------	-----------	-----------	-----------	-----------	-----------	-----------	-----------	-----------	-----------	-----------	-----------	-----------	-----------	-----------	-----------	-----------	-----------	-----------	-----------	-----------	-----------	-----------	-----------	-----------	-----------	-----------	-----------	-----------	-----------	-----------	-----------	-----------	-----------	-----------	-----------	-----------	-----------	-----------	-----------	-----------	-----------	-----------	-----------	-----------	-----------	-----------	-----------	-----------	-----------	-----------	-----------	-----------	-----------	-----------	-----------	-----------	-----------	-----------	-----------	-----------	-----------	-----------	-----------	-----------	-----------	-----------	-----------	-----------	-----------	-----------	-----------	-----------	-----------	-----------	-----------	-----------	-----------	-----------	-----------	-----------	-----------	-----------	-----------	-----------	-----------	-----------	-----------	-----------	-----------	-----------	-----------	-----------	-----------	-----------	-----------	-----------	-----------	-----------	-----------	-----------	-----------	-----------	-----------	-----------	-----------	-----------	-----------	-----------	-----------	-----------	-----------	-----------	-----------	-----------	-----------	-----------	-----------	-----------	-----------	-----------	-----------	-----------	-----------	-----------	-----------	-----------	-----------	-----------	-----------	-----------	-----------	-----------	-----------	-----------	-----------	-----------	-----------	-----------	-----------	-----------	-----------	-----------	-----------	-----------	-----------	-----------	-----------	-----------	-----------	-----------	-----------	-----------	-----------	-----------	-----------	-----------	-----------	-----------	-----------	-----------	-----------	-----------	-----------	-----------	-----------	-----------	-----------	-----------	-----------	-----------	-----------	-----------	-----------	-----------	-----------	-----------	-----------	-----------	-----------	-----------	-----------	-----------	-----------	-----------	-----------	-----------	-----------	-----------	-----------	-----------	-----------	-----------	-----------	-----------	-----------	-----------	-----------	-----------	-----------	-----------	-----------	-----------	-----------	-----------	-----------	-----------	-----------	-----------	-----------	-----------	-----------	-----------	-----------	-----------	-----------	-----------	-----------	-----------	-----------	-----------	-----------	-----------	-----------	-----------	-----------	-----------	-----------	-----------	-----------	-----------	-----------	-----------	-----------	-----------	-----------	-----------	-----------	-----------	-----------	-----------	-----------	-----------	-----------	-----------	-----------	-----------	-----------	-----------	-----------	-----------	-----------	-----------	-----------	-----------	-----------	-----------	-----------	-----------	-----------	-----------	-----------	-----------	-----------	-----------	-----------	-----------	-----------	-----------	-----------	-----------	-----------	-----------	-----------	-----------	-----------	-----------	-----------	-----------	-----------	-----------	-----------	-----------	-----------	-----------	-----------	-----------	-----------	-----------	-----------	-----------	-----------	-----------	-----------	-----------	-----------	-----------	-----------	-----------	-----------	-----------	-----------	-----------	-----------	-----------	-----------	-----------	-----------	-----------	-----------	-----------	-----------	-----------	-----------	-----------	-----------	-----------	-----------	-----------	-----------	-----------	-----------	-----------	-----------	-----------	-----------	-----------	-----------	-----------	-----------	-----------	-----------	-----------	-----------	-----------	-----------	-----------	-----------	-----------	-----------	-----------	-----------	-----------	-----------	-----------	-----------	-----------	-----------	-----------	-----------	-----------	-----------	-----------	-----------	-----------	-----------	-----------	-----------	-----------	-----------	-----------	-----------	-----------	-----------	-----------	-----------	-----------	-----------	-----------	-----------	-----------	-----------	-----------	-----------	-----------	-----------	-----------	-----------	-----------	-----------	-----------	-----------	-----------	-----------	-----------	-----------	-----------	-----------	-----------	-----------	-----------	-----------	-----------	-----------	-----------	-----------

**FUTURE ANNEXATION AREA
COMMUNITY FACILITIES DISTRICT NO. 17 - I
(WESTERN CHULA VISTA DIF FINANCING)**

CITY OF CHULA VISTA, COUNTY OF SAN DIEGO, STATE OF CALIFORNIA

APN #	APN #	APN #	APN #	APN #	APN #	APN #	APN #	APN #	APN #	APN #	APN #	APN #	APN #	APN #	APN #	APN #	APN #
629020202	629130140	629060278	629110545	644040850	644230110	775670361	775670366	775670373	775670382	775670396	775670910	7756721045	7757107349	775691251	775691322	775691322	775691322
629020203	629130160	629060279	629110546	644040851	644230120	775670362	775670367	775670374	775670383	775670397	775670911	7756721046	7757107350	775691252	775691323	775691323	775691323
629020204	629130170	629060280	629110547	644040852	644230130	775670363	775670368	775670375	775670384	775670403	775670912	7756721047	7757107351	775691253	775691324	775691324	775691324
629020205	629130180	629060281	629110548	644040853	644230140	775670364	775670369	775670376	775670385	775670404	775670913	7756721048	7757107352	775691254	775691325	775691325	775691325
629020206	629130210	629060282	629110549	644040854	644230150	775670365	775670370	775670377	775670386	775670405	775670914	7756721049	7757107353	775691255	775691326	775691326	775691326
629020207	629130220	629060283	629110550	644040855	644230160	775670366	775670371	775670378	775670387	775670406	775670915	7756721050	7757107354	775691256	775691327	775691327	775691327
629020208	629130230	629060284	629110551	644040856	644230170	775670367	775670372	775670379	775670388	775670407	775670916	7756721051	7757107355	775691257	775691328	775691328	775691328
629020209	629130240	629060285	629110552	644040857	644230180	775670368	775670373	775670380	775670389	775670408	775670917	7756721052	7757107356	775691258	775691329	775691329	775691329
629020210	629130250	629060286	629110553	644040858	644230190	775670369	775670374	775670381	775670390	775670409	775670918	7756721053	7757107357	775691259	775691330	775691330	775691330
629020211	629130260	629060287	629110554	644040859	644230200	775670370	775670375	775670382	775670391	775670410	775670919	7756721054	7757107358	775691260	775691331	775691331	775691331
629020212	629130270	629060288	629110555	644040860	644230210	775670371	775670376	775670383	775670392	775670411	775670920	7756721055	7757107359	775691261	775691332	775691332	775691332
629100040	629130280	629060289	629110556	644040861	644230220	775670372	775670377	775670384	775670393	775670412	775670921	7756721056	7757107360	775691262	775691333	775691333	775691333
629100080	629130290	629060290	629110557	644040862	644230230	775670373	775670378	775670385	775670394	775670413	775670922	7756721057	7757107361	775691263	775691334	775691334	775691334
629100140	629130300	629060291	629110558	644040863	644230240	775670374	775670379	775670386	775670395	775670414	775670923	7756721058	7757107362	775691264	775691335	775691335	775691335
629100190	629130310	629060292	629110559	644040864	644230250	775670375	775670380	775670387	775670396	775670415	775670924	7756721059	7757107363	775691265	775691336	775691336	775691336
629100240	629130320	629060293	629110560	644040865	644230260	775670376	775670381	775670388	775670397	775670416	775670925	7756721060	7757107364	775691266	775691337	775691337	775691337
629100290	629130330	629060294	629110561	644040866	644230270	775670377	775670382	775670389	775670398	775670417	775670926	7756721061	7757107365	775691267	775691338	775691338	775691338
629100340	629130340	629060295	629110562	644040867	644230280	775670378	775670383	775670390	775670399	775670418	775670927	7756721062	7757107366	775691268	775691339	775691339	775691339
629100390	629130350	629060296	629110563	644040868	644230290	775670379	775670384	775670391	775670400	775670419	775670928	7756721063	7757107367	775691269	775691340	775691340	775691340
629100440	629130360	629060297	629110564	644040869	644230300	775670380	775670385	775670392	775670401	775670420	775670929	7756721064	7757107368	775691270	775691341	775691341	775691341
629100490	629130370	629060298	629110565	644040870	644230310	775670381	775670386	775670393	775670402	775670421	775670930	7756721065	7757107369	775691271	775691342	775691342	775691342
629100540	629130380	629060299	629110566	644040871	644230320	775670382	775670387	775670394	775670403	775670422	775670931	7756721066	7757107370	775691272	775691343	775691343	775691343
629100590	629130390	629060300	629110567	644040872	644230330	775670383	775670388	775670395	775670404	775670423	775670932	7756721067	7757107371	775691273	775691344	775691344	775691344
629100640	629130400	629060301	629110568	644040873	644230340	775670384	775670389	775670396	775670405	775670424	775670933	7756721068	7757107372	775691274	775691345	775691345	775691345
629100690	629130410	629060302	629110569	644040874	644230350	775670385	775670390	775670397	775670406	775670425	775670934	7756721069	7757107373	775691275	775691346	775691346	775691346
629100740	629130420	629060303	629110570	644040875	644230360	775670386	775670391	775670398	775670407	775670426	775670935	7756721070	7757107374	775691276	775691347	775691347	775691347
629100790	629130430	629060304	629110571	644040876	644230370	775670387	775670392	775670399	775670408	775670427	775670936	7756721071	7757107375	775691277	775691348	775691348	775691348
629100840	629130440	629060305	629110572	644040877	644230380	775670388	775670393	775670400	775670409	775670428	775670937	7756721072	7757107376	775691278	775691349	775691349	775691349
629100890	629130450	629060306	629110573	644040878	644230390	775670389	775670394	775670401	775670410	775670429	775670938	7756721073	7757107377	775691279	775691350	775691350	775691350
629100940	629130460	629060307	629110574	644040879	644230400	775670390	775670395	775670402	775670411	775670430	775670939	7756721074	7757107378	775691280	775691351	775691351	775691351
629100990	629130470	629060308	629110575	644040880	644230410	775670391	775670396	775670403	775670412	775670431	775670940	7756721075	7757107379	775691281	775691352	775691352	775691352
629101040	629130480	629060309	629110576	644040881	644230420	775670392	775670397	775670404	775670413	775670432	775670941	7756721076	7757107380	775691282	775691353	775691353	775691353
629101090	629130490	629060310	629110577	644040882	644230430	775670393	775670398	775670405	775670414	775670433	775670942	7756721077	7757107381	775691283	775691354	775691354	775691354
629101140	629130500	629060311	629110578	644040883	644230440	775670394	775670399	775670406	775670415	775670434	775670943	7756721078	7757107382	775691284	775691355	775691355	775691355
629101190	629130510	629060312	629110579	644040884	644230450	775670395	775670400	775670407	775670416	775670435	775670944	7756721079	7757107383	775691285	775691356	775691356	775691356
629101240	629130520	629060313	629110580	644040885	644230460	775670396	775670401	775670408	775670417	775670436	775670945	7756721080	7757107384	775691286	775691357	775691357	775691357
629101290	629130530	629060314	629110581	644040886	644230470	775670397	775670402	775670409	775670418	775670437	775670946	7756721081	7757107385	775691287	775691358	775691358	775691358
629101340	629130540	629060315	629110582	644040887	644230480	775670398	775670403	775670410	775670419	775670438	775670947	7756721082	7757107386	775691288	775691359	775691359	775691359
629101390	629130550	629060316	629110583	644040888	644230490	775670399	775670404	775670411	775670420	775670439	775670948	7756721083	7757107387	775691289	775691360	775691360	775691360
629101440	629130560	629060317	629110584	644040889	644230500	775670400	775670405	775670412	775670421	775670440	775670949	7756721084	7757107388	775691290	775691361	775691361	775691361
629101490	629130570	629060318	629110585	644040890	644230510	775670401	775670406	775670413	775670422	775670441	775670950	7756721085	7757107389	775691291	775691362	775691362	775691362
629101540	629130580	629060319	629110586	644040891	644230520	775670402	775670407	775670414	775670423	775670442	775670951	7756721086	7757107390	775691292	775691363	775691363	775691363
629101590	629130590	629060320	629110587	644040892	644230530	775670403	775670408	775670415	775670424	775670443	775670952	7756721087	7757107391	775691293	775691364	775691364	775691364
629101640	629130600	629060321	629110588	644040893	644230540	775670404	775670409	775670416	775670425	775670444	775670953	7756721088	7757107392	775691294	775691365	775691365	775691365
629101690	629130610	629060322	629110589	644040894	644230550	775670405	775670410	775670417	775670426	775670445	775670954	7756721089	7757107393	775691295	775691366	775691366	775691366
629101740	629130620	629060323	629110590	644040895	644230560	775670406	775670411	775670418	775670427	775670446	775670955	7756721090	7757107394	775691296	775691367	775691367	775691367
629101790	629130630	629060324	629110591	6440													

EXHIBIT C

Rate and Method of Apportionment

Rate and Method of Apportionment of Special Tax Community Facilities District No. 17-I (Western Chula Vista DIF Financing)

A Special Tax shall be levied on each Assessor's Parcel of Taxable Property within the boundaries of Community Facilities District No. 17-I (Western Chula Vista DIF Financing) of the City of Chula Vista (the "City") and collected each Fiscal Year commencing in Special Tax Commencement FY applicable to such Assessor's Parcel, in an amount determined by the CFD Administrator through the application of the procedures described below. All of the real property within CFD No. 17-I, unless exempted by law or by the provisions hereof, shall be taxed for the purposes, to the extent, and in the manner herein provided.

1. DEFINITIONS

The terms hereinafter set forth have the following meanings:

"Accrued Interest Obligation" means for each Assessor's Parcel, the amount of interest accrued on the Deferred DIF Obligation from the date of the issuance or grant of a Certificate of Occupancy for such property as determined in accordance with Section 3.D below.

"Acre" or "Acreage" means the land area of an Assessor's Parcel as shown on an Assessor's Parcel Map, or if the land area is not shown on an Assessor's Parcel Map, the land area shown on the applicable Final Map. An Acre means 43,560 square feet of land.

"Act" means the Mello-Roos Community Facilities Act of 1982, as amended, being Chapter 2.5 of Part 1 of Division 2 of Title 5 of the Government Code of the State of California.

"Annual Special Tax" means the Special Tax actually levied in any Fiscal Year on any Assessor's Parcel which is equal to the sum of the Annual Special Tax for Facilities and the Annual Special Tax for Accrued Interest in accordance with Section 3.E below.

"Annual Special Tax for Facilities" means the amount of the Special Tax levied on an Assessor's Parcel of Developed Property in any Fiscal Year, commencing with the Special Tax Commencement FY, to satisfy the repayment of the Deferred DIF Obligation over the term of the Special Tax as set forth in Section 7 determined in accordance with Section 3.E below unless the Special Tax Obligation is prepaid pursuant to the provisions of Section 6 thereto.

"Annual Special Tax for Accrued Interest" means the amount levied on an Assessor's Parcel of Developed Property in any Fiscal Year, commencing with the Special Tax Commencement FY, to satisfy the repayment of the Accrued Interest Obligation over the term of the Special Tax as set forth in Section 7 determined in accordance with Section 3.E below unless the Special Tax Obligation is prepaid pursuant to the provisions of Section 6 thereto..

"Annual Special Tax for Current Interest" means the amount levied on an Assessor's Parcel of Developed Property in any Fiscal Year, commencing with the Special Tax Commencement FY, to satisfy

the requirement to pay interest on unpaid deferred fees during the 20-year repayment period commencing with the Special Tax Commencement FY and ending on June 30th of the Special Tax Final Year.

“Assessor” means the Assessor of the County of San Diego.

“Assessor's Parcel” means a lot or parcel shown on an Assessor's Parcel Map with an assigned Assessor's Parcel Number.

“Assessor's Parcel Map” means an official map of the Assessor designating parcels by Assessor's Parcel Number.

“Assessor's Parcel Number” means the number assigned to an Assessor's Parcel by the Assessor for purposes of identification.

“Assigned Special Tax Obligation” means for each Assessor's Parcel, the amount determined in accordance with Section 3.B below.

“Building Permit” means a building permit issued by the City for construction of a Residential Unit or Non-Residential Property located within CFD No. 17-I.

“Building Square Footage” means all of the square footage of usable area within the perimeter of a residential structure, not including any carport, walkway, garage, overhang, or similar area. The determination of Building Square Footage shall be made by reference to the Building Permit(s) issued for such Assessor's Parcel and/or by reference to appropriate records kept by the City.

“Certificate of Occupancy” means a certificate issued or approval granted by the City, or other applicable government entity, that authorizes the actual occupancy of a Residential Unit for habitation by one or more residents or the occupancy of Non-Residential Property.

“CFD Administrator” means an authorized representative of the City, or designee thereof, responsible for determining the Assigned Special Tax Obligation and the Annual Special Tax, for preparing the Annual Special Tax roll and/or calculating the Backup Special Tax.

“CFD No. 17-I” means the City of Chula Vista Community Facilities District No. 17-I (Western Chula Vista DIF Financing).

“City” means the City of Chula Vista, California.

“Council” means the City Council of the City acting as the legislative body of CFD No. 17-I under the Act.

“County” means the County of San Diego, California.

“Deferred DIF Obligation” means for each Assessor's Parcel, the remaining balance of DIFs that have been deferred on such Assessor's Parcel since Building Permit issuance as determined in accordance with Section 3.C below.

“Developed Property” means for each Fiscal Year, all Taxable Property for which a Building Permit was issued prior to May 1 of the previous Fiscal Year. An Assessor's Parcel classified as Developed Property but for which the Building Permit that caused such Assessor's Parcel to be classified as Developed Property has been cancelled and/or voided prior to the Fiscal Year for which Special Taxes are being levied shall be reclassified as Undeveloped Property.

“DIF Deferral Agreement” means, as to an Assessor’s Parcel, the Agreement for Deferral of Development Impact Fees by and between the owner of such Assessor’s Parcel and the City.

“DIF” or **“DIFs”** shall, as to an Assessor’s Parcel, have the meaning given such terms in the DIF Deferral Agreement applicable to such Assessor’s Parcel.

“Effective Date” shall mean, as to each DIF Deferral Agreement, the effective date of such agreement as specified therein.

“Exempt Property” means for each Fiscal Year, all Assessor’s Parcels designated as being exempt from Special Taxes pursuant to Section 8 below.

“Final Map” means a subdivision of property by recordation of a final map, parcel map, or lot line adjustment, pursuant to the Subdivision Map Act (California Government Code Section 66410 et seq.) or recordation of a condominium plan pursuant to California Civil Code 4285 that creates individual lots for which Building Permits may be issued without further subdivision.

“Fiscal Year” means the period starting on July 1 and ending the following June 30.

“Initial Interest Accrual Date” shall mean, as to any Assessor’s Parcel of Developed Property, the date on which the Certificate of Occupancy for such Assessor’s Parcel is issued.

“Initial Accrued Interest Obligation FY” shall mean, as to any Assessor’s Parcel of Developed Property, the Fiscal Year in which the Initial Interest Accrual Date for such Assessor’s Parcel falls.

“Maximum Special Tax Obligation” means for each Assessor’s Parcel, the amount assigned in accordance with Sections 3.A below.

“Non-Residential Property” means all Assessor’s Parcels of Developed Property for which a building permit has been issued for the purpose of constructing one or more non-residential structures or facilities.

“Original Parcel” means an Assessor’s Parcel within the boundaries of CFD No. 17-I that was assigned a Maximum Special Tax Obligation and an Assigned Special Tax Obligation in the prior Fiscal Year but has been subsequently subdivided into Successor Parcels for the current Fiscal Year.

“Prepayment Amount” means the amount required to prepay the Annual Special Tax obligation in full for an Assessor’s Parcel as described in Section 6.A below.

“Property Owner Association Property” means any Assessor’s Parcel within the boundaries of CFD No. 17-I owned in fee by a property owner association, including any master or sub-association.

“Public Property” means any property within the boundaries of CFD No. 17-I, which is owned by, or irrevocably offered for dedication to the federal government, the State of California, the County, the City or any other public agency; provided however that any property owned by a public agency and leased to a private entity and subject to taxation under Section 53340.1 of the Act shall be taxed and classified in accordance with its use.

“Residential Property” means all Assessor’s Parcels of Developed Property for which a Building Permit has been issued for the purpose of constructing one or more Residential Units.

“Residential Unit” means each separate residential dwelling unit that comprises an independent facility capable of conveyance or rental, separate from adjacent residential dwelling units.

“Special Tax” means any special tax levied within CFD No. 17-I pursuant to the Act and this Rate and Method of Apportionment of Special Tax.

“Special Tax Commencement FY” shall mean, as to each Assessor’s Parcel classified as Developed Property, the Fiscal Year falling after the first day of the eleventh calendar year after the Effective Date of the DIF Deferral Agreement applicable to such Assessor’s Parcel.

“Special Tax Final FY” shall mean, as to each Assessor’s Parcel of Developed Property, the Fiscal Year commencing on July 1 of nineteenth (19th) Fiscal Year following the Special Tax Commencement FY.

“Special Tax Obligation” means the total obligation of an Assessor’s Parcel of Developed Property to pay the Special Tax for the remaining term of the Special Tax applicable to such Assessor’s Parcel.

“Successor Parcel” means an Assessor’s Parcel created by the Subdivision of one or more Original Parcels pursuant to Section 4 below.

“State” means the State of California.

“Taxable Property” means all of the Assessor's Parcels within the boundaries of CFD No. 17-I, which are not exempt from the levy of the Special Tax pursuant to law or Section 8 below.

“Undeveloped Property” means, for each Fiscal Year, all Taxable Property not classified as Developed Property.

2. LAND USE CLASSIFICATION

Each Fiscal Year, beginning with Fiscal Year 2016-17, each Assessor’s Parcel within CFD No. 17-I shall be classified as Taxable Property or Exempt Property. In addition, all Taxable Property shall further be classified as Developed Property or Undeveloped Property, and all such Taxable Property shall be subject to the levy of Special Taxes in accordance with this Rate and Method of Apportionment of Special Tax determined pursuant to Sections 3 and 4 below.

3. SPECIAL TAX RATES

A. Maximum Special Tax Obligation

The Maximum Special Tax Obligation applicable to an Assessor's Parcel subject to a DIF Deferral Agreement in the Initial Fiscal Year applicable to such Assessor’s Parcel shall be determined pursuant to Table 1 below.

Table 1
Initial Fiscal Year Maximum Special Tax Obligation

Assessor’s Parcel No.	Maximum Special Tax Obligation
618-010-17	\$1,600,000

Commencing on July 1 of the Fiscal Year following the Initial Interest Accrual Date, the Maximum Special Tax Obligation for such Assessor’s Parcel shall increase on July 1 of each Fiscal Year by an amount equal to two percent (2%) of the Maximum Special Tax Obligation in effect for the prior Fiscal Year.

B. Assigned Special Tax Obligation

On July 1 of each Fiscal Year commencing the Special Tax Commencement FY, the CFD Administrator shall determine the Assigned Special Tax Obligation for that Fiscal Year.

The Assigned Special Tax Obligation in any given Fiscal Year commencing the Special Tax Commencement FY shall be the sum of the Deferred DIF Obligation plus the Accrued Interest Obligation. If for any Fiscal Year the Assigned Special Tax Obligation is determined to be greater than the Maximum Special Tax Obligation, then the Assigned Special Tax Obligation shall be equal to the Maximum Special Tax Obligation.

C. Deferred DIF Obligation

The Deferred DIF Obligation applicable to an Assessor's Parcel classified as Undeveloped Property shall be zero.

The initial Deferred DIF Obligation applicable to an Assessor's Parcel classified as Developed Property shall be determined by the CFD Administrator at the time of issuance of a Building Permit for such Assessor's Parcel. The Deferred DIF Obligation shall be equal to the sum of the applicable DIFs specified in the DIF Deferral Agreement for each Building Permit issued for Assessor's Parcels within CFD No. 17-I. The amount of each DIF included in the DIF Fee Obligation for an Assessor's Parcel shall be based on the fee schedule applicable to such DIF in effect at the time of issuance of such Building Permit.

The Deferred DIF Obligation in any Fiscal Year applicable to an Assessor's Parcel of Developed Property shall be equal to the Deferred DIF Obligation in the prior Fiscal Year less any Annual Special Tax for Facilities payments made in the prior Fiscal Year.

If a partial prepayment is made pursuant to Section 6.B below, the Deferred DIF Obligation will also be reduced by the applicable amount of the Deferred DIF Obligation that was prepaid.

D. Accrued Interest Obligation

The Accrued Interest Obligation in the Initial Fiscal Year applicable to an Assessor's Parcel classified as Developed Property for which a Certificate of Occupancy has not been issued prior to July 1 of such Fiscal Year shall be zero.

The Accrued Interest Obligation applicable to any Assessor's Parcel classified as Developed Property shall commence to accrue on the Initial Interest Accrual Date. The Accrued Interest Obligation applicable to such Assessor's Parcel in the Initial Accrued Interest Obligation FY shall be equal to two percent (2%) of the Deferred DIF Obligation as of July 1 of such Fiscal Year multiplied by a fraction the numerator of which is the number of calendar days from and including the Initial Interest Accrual Date to and including June 30th of such Fiscal Year and the denominator of which is 365. The Accrued Interest Obligation for each subsequent Fiscal Year prior to the Special Tax Commencement FY shall be equal to the Accrued Interest Obligation in the prior Fiscal Year plus two percent (2%) of the Deferred DIF Obligation as of July 1 of the prior Fiscal Year.

The Accrued Interest Obligation in the Special Tax Commencement FY and each subsequent Fiscal Year applicable to an Assessor's Parcel classified as Developed Property shall be equal to

the Accrued Interest Obligation as of July 1 of the prior Fiscal Year less any Annual Special Tax for Accrued Interest payments made in the prior Fiscal Year.

If a partial prepayment is made pursuant to Section 6.B below, the Deferred DIF Obligation will also be reduced by the applicable amount of the Accrued Interest Obligation that was prepaid.

E. Annual Special Tax

The Annual Special Tax for Developed Property in any Fiscal Year commencing the Special Tax Commencement FY shall be equal to (i) the Annual Special Tax for Facilities plus (ii) the Annual Special Tax for Accrued Interest plus (iii) the Annual Special Tax for Current Interest.

The Annual Special Tax for Facilities in any Fiscal Year commencing the Special Tax Commencement FY shall be equal to the Deferred DIF Obligation on July 1 of the Special Tax Commencement FY times the Repayment Rate in Table 2 below that corresponds with such Fiscal Year. In each subsequent Fiscal Year, the Annual Special Tax for Facilities will remain unchanged until the Deferred DIF Obligation is paid in full.

The Annual Special Tax for Accrued Interest in any Fiscal Year commencing the Special Tax Commencement FY shall be equal to the Accrued Interest Obligation on July 1 of the Special Tax Commencement FY times the Repayment Rate in Table 2 below that corresponds with such Fiscal Year. In each subsequent Fiscal Year, the Annual Special Tax for Accrued Interest will remain unchanged until the Accrued Interest Obligation is paid in full.

The Annual Special Tax for Current Interest in any Fiscal Year commencing the Special Tax Commencement FY shall be equal to the Deferred DIF Obligation on July 1 of such Fiscal Year times the Current Interest Rate in Table 2 below that corresponds with such Fiscal Year.

Table 2
Amortization Table

Fiscal Year	Repayment Rate	Current Interest Rate
Initial Accrued Interest Obligation FY through the Fiscal Year preceding the Special Tax Commencement FY	0%	0%
Special Tax Commencement FY through the Special Tax Final FY	5%	2%

4. METHOD OF APPORTIONMENT

Commencing with the Special Tax Commencement FY and for each following Fiscal Year, the CFD Administrator shall apportion the Assigned Special Tax Obligation as set forth below.

First: All Original Parcels that are reflected on the Assessor’s Parcel Maps applicable to the current Fiscal Year will be assigned a Maximum Special Tax Obligation and Assigned Special Tax Obligation in accordance with Section 3 above.

Second: All Original Parcels that are not reflected on the Assessor’s Parcel Maps applicable to the current Fiscal Year will be assigned a Maximum Special Tax Obligation and Assigned Special Tax Obligation in accordance with Section 3 above as if such parcels still existed in their previous form.

Third: The Maximum Special Tax Obligation and Assigned Special Tax Obligation that were calculated in the Second step above will be assigned to each applicable Successor Parcel based on the amount of Taxable Acreage contained in such Successor Parcel divided by the amount of Taxable Acreage contained in the relevant Original Parcel. The sum of the Maximum Special Tax Obligations of each group of Successor Parcels shall be equal to Maximum Special Tax Obligation of the applicable Original Parcel that was determined in the Second step. Likewise, the sum of the Assigned Special Tax Obligations of each group of Successor Parcels shall be equal to Assigned Special Tax Obligation of the applicable Original Parcel that was determined in the Second step.

Fourth: The Special Tax shall be levied on each Assessor’s Parcel of Developed Property at 100% of the applicable Annual Special Tax.

Successor Parcels that are assigned a Maximum Special Tax Obligation and an Assigned Special Tax Obligation in the current Fiscal Year will be considered Original Parcels in the following Fiscal Year.

Notwithstanding the above, under no circumstances will the Special Tax levied in any Fiscal Year against any Assessor's Parcel of Residential Property for which an occupancy permit for private residential use has been issued be increased as a result of a delinquency or default in the payment of the Special Tax applicable to any other Assessor's Parcel within CFD No. 17-I by more than ten percent (10%) above what would have been levied in the absence of such delinquencies or defaults.

5. COLLECTION OF SPECIAL TAXES

Collection of the Annual Special Tax shall be made by the County in the same manner as ordinary ad valorem property taxes are collected and the Annual Special Tax shall be subject to the same penalties and the same lien priority in the case of delinquency as ad valorem taxes; provided, however, that the Council may provide for (i) other means of collecting the Special Tax, including direct billings thereof to the property owners; and (ii) judicial foreclosure of delinquent Annual Special Taxes.

6. PREPAYMENT OF SPECIAL TAX OBLIGATION

A. Prepayment in Full

Property owners may prepay and permanently satisfy the Special Tax Obligation by a cash settlement with the City as permitted under Government Code Section 53344.

The Special Tax Obligation applicable to an Assessor's Parcel of Developed Property, or Undeveloped Property for which a Building Permit has been issued may be prepaid and the obligation to pay the Special Tax for such Assessor's Parcel permanently satisfied as described herein, provided that a prepayment may be made with respect to a particular Assessor's Parcel only if there are no delinquent Special Taxes with respect to such Assessor's Parcel at the time of prepayment. An owner of an Assessor's Parcel eligible to prepay the Special Tax Obligation shall provide the CFD Administrator with written notice of intent to prepay, and designate or identify the company or agency that will be acting as the escrow agent, if any. The CFD Administrator shall provide the owner with a statement of the Prepayment Amount for such Assessor's Parcel within thirty (30) days of the request, and may charge a reasonable fee for providing this service. The Prepayment Amount (defined below) shall be calculated for each applicable Assessor's Parcel or group of Assessor's Parcels as summarized below (capitalized terms as defined below):

Deferred DIF Obligation
plus Accrued Interest Obligation
plus Prepayment Administrative Fees and Expenses
Total: equals Prepayment Amount

As of the proposed date of prepayment, the Prepayment Amount (defined in Step 14 below) shall be calculated as follows:

Step No.:

1. Confirm that no Special Tax delinquencies apply to such Assessor's Parcel.
2. For Assessor's Parcels of Developed Property, determine the Deferred DIF Obligation and the Accrued Interest Obligation. For Assessor's Parcels of Undeveloped Property for which a Building Permit has been issued, compute the Deferred DIF Obligation for that Assessor's Parcel as though it was already designated as Developed Property, based upon the Building Permit which has already been issued for that Assessor's Parcel.
3. Calculate the administrative fees and expenses of CFD No. 17-I, including the costs of computation of the prepayment, the costs to invest the prepayment proceeds, the costs of redeeming CFD No. 17-I, and the costs of recording any notices to evidence the prepayment and the redemption (the "Prepayment Administrative Fees").
4. The amount to prepay the Special Tax Obligation is equal to the sum of the amounts computed pursuant to paragraphs 1, 2 and 3 (the "Prepayment Amount").
5. The Prepayment Amount shall be deposited into the Construction Fund. The amount computed pursuant to paragraph 3 shall be retained by CFD No. 17-I.

The CFD Administrator will confirm that all previously levied Special Taxes have been paid in full. With respect to any Assessor's Parcel for which the Special Tax Obligation is prepaid in full, once the CFD Administrator has confirmed that all previously levied Special Taxes have been paid, the Council shall cause a suitable notice to be recorded in compliance with the Act, to indicate the prepayment of the Special Tax and the release of the Special Tax lien on such Assessor's Parcel, and the obligation of the owner of such Assessor's Parcel to pay the Special Tax shall cease.

B. Partial Prepayment

The Special Tax on an Assessor's Parcel of Developed Property or Undeveloped Property for which a building permit has been issued may be partially prepaid. The amount of the prepayment shall be calculated as in Section 6.A, except that a partial prepayment shall be calculated according to the following formula:

$$PP = (PE - A) \times F + A$$

These terms have the following meaning:

PP = the partial prepayment

PE = the Prepayment Amount calculated according to Section 6.A

F = the percentage by which the owner of the Assessor's Parcel(s) is partially prepaying the Special Tax Obligation

A = the Prepayment Administrative Fees and Expenses from Section 6.A

The owner of any Assessor's Parcel who desires such partial prepayment shall notify the CFD Administrator of (i) such owner's intent to partially prepay the Special Tax Obligation, (ii) the percentage by which the Special Tax Obligation shall be prepaid, and (iii) the company or agency that will be acting as the escrow agent, if any. The CFD Administrator shall provide the owner with a statement of the amount required for the partial prepayment of the Special Tax

Obligation for an Assessor's Parcel within sixty (60) days of the request and may charge a reasonable fee for providing this service.

With respect to any Assessor's Parcel that is partially prepaid, the City shall (i) distribute the funds remitted to it according to Section 6.A., and (ii) indicate in the records of CFD No. 17-I that there has been a partial prepayment of the Special Tax Obligation and that the remaining Special Tax Obligation of such Assessor's Parcel, equal to the outstanding percentage (1.00 - F) of the Deferred DIF Obligation and the Accrued Interest Obligation, shall continue to be levied on such Assessor's Parcel in the same manner as before the Partial Prepayment.

7. TERM OF SPECIAL TAX

The Special Tax shall be levied as long as necessary to satisfy the Assigned Special Tax Obligation for a period not to exceed thirty (30) Fiscal Years commencing with Special Tax Commencement FY, provided however that the Special Tax will cease to be levied in an earlier Fiscal Year if the CFD Administrator has determined that all CFD No. 17-I obligations have been satisfied.

8. EXEMPTIONS

The CFD Administrator shall classify as Exempt Property (i) Assessor's Parcels of Public Property, (ii) Assessor's Parcels of Property Owner Association Property, or (iii) Assessor's Parcels which are used as places of worship and are exempt from ad valorem property taxes because they are owned by a religious organization, (iv) Assessor's Parcels with public or utility easements making impractical their utilization for other than the purposes set forth in the easement, and (v) Assessor's Parcels of Developed Property classified as Non-Residential Property as determined reasonably by the CFD Administrator.

If the use of an Assessor's Parcel of Exempt Property changes so that such Assessor's Parcel is no longer classified as one of the uses set forth in the first paragraph of Section 8 above that would make such Assessor's Parcel eligible to be classified as Exempt Property, such Assessor's Parcel shall cease to be classified as Exempt Property and shall be deemed to be Taxable Property.

9. APPEALS

Any landowner who pays the Special Tax and claims the amount of the Special Tax levied on his or her Assessor's Parcel is in error shall first consult with the CFD Administrator regarding such error not later than thirty-six (36) months after first having paid the first installment of the Special Tax that is disputed. If following such consultation the CFD Administrator determines that an error has occurred, then the CFD Administrator shall take any of the following actions, in order of priority, in order to correct the error:

(i) Amend the Special Tax levy on the landowner's Assessor's Parcel(s) for the current Fiscal Year prior to the payment date,

(ii) Require the CFD to reimburse the landowner for the amount of the overpayment to the extent of available CFD funds, or

(iii) Grant a credit against, eliminate or reduce the future Special Taxes on the landowner's Assessor's Parcel(s) in the amount of the overpayment.

If following such consultation and action by the CFD Administrator the landowner believes such error still exists, such person may file a written notice of appeal with the City Council. Upon the receipt of such notice, the City Council or designee may establish such procedures as deemed necessary to

undertake the review of any such appeal. If the City Council or designee determines an error still exists, the CFD Administrator shall take any of the actions described as (i), (ii) and (iii) above, in order of priority, in order to correct the error.

The City Council or designee thereof shall interpret this Rate and Method of Apportionment of Special Tax for purposes of clarifying any ambiguities and make determinations relative to the administration of the Special Tax and any landowner appeals. The decision of the City Council or designee shall be final.