

I HEREBY CERTIFY THAT THE WITHIN MAP SHOWING PROPOSED BOUNDARIES OF COMMUNITY FACILITIES DISTRICT NO. 14M-2 (EASTERN URBAN CENTER), CITY OF CHULA VISTA, COUNTY OF SAN DIEGO, STATE OF CALIFORNIA, WAS APPROVED BY THE CITY COUNCIL OF THE CITY OF CHULA VISTA AT A REGULAR MEETING THEREOF, HELD ON 24<sup>th</sup> DAY OF March, 2019, BY RESOLUTION NO. 2019-037

*Kumpaka*  
CITY CLERK  
CITY OF CHULA VISTA



FILED IN THE OFFICE OF THE CITY CLERK, CITY OF CHULA VISTA, THIS 24<sup>th</sup> DAY OF March, 2019.

*Kumpaka*  
CITY CLERK  
CITY OF CHULA VISTA

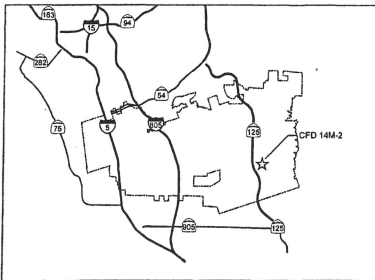

THIS BOUNDARY MAP CORRECTLY SHOWS THE BOUNDARIES OF THE COMMUNITY FACILITIES DISTRICT. FOR DETAILS CONCERNING THE LINES AND DIMENSIONS OF LOTS OR PARCEL REFER TO THE COUNTY ASSESSOR'S MAPS FOR FISCAL YEAR 2018-19.

**PROPOSED BOUNDARIES OF  
COMMUNITY FACILITIES DISTRICT NO. 14M-2  
(EASTERN URBAN CENTER/MILLENNIA)  
CITY OF CHULA VISTA,  
COUNTY OF SAN DIEGO, STATE OF CALIFORNIA**

SHEET 1 OF 1 SHEET

RECORDED THIS 5<sup>th</sup> DAY OF APRIL, 2019, AT THE HOUR OF 10:55 O'CLOCK A.M. IN BOOK 47, PAGE 83, OF MAPS OF ASSESSMENT AND COMMUNITY FACILITIES DISTRICTS IN THE OFFICE OF THE COUNTY RECORDER, IN THE COUNTY OF SAN DIEGO, STATE OF CALIFORNIA.

FEE: \$9.00 NO.: 2019-7000131  
ERNEST J. DRONENBURG, JR., ASSESSOR, RECORDER,  
COUNTY CLERK

BY: *[Signature]*  
DEPUTY

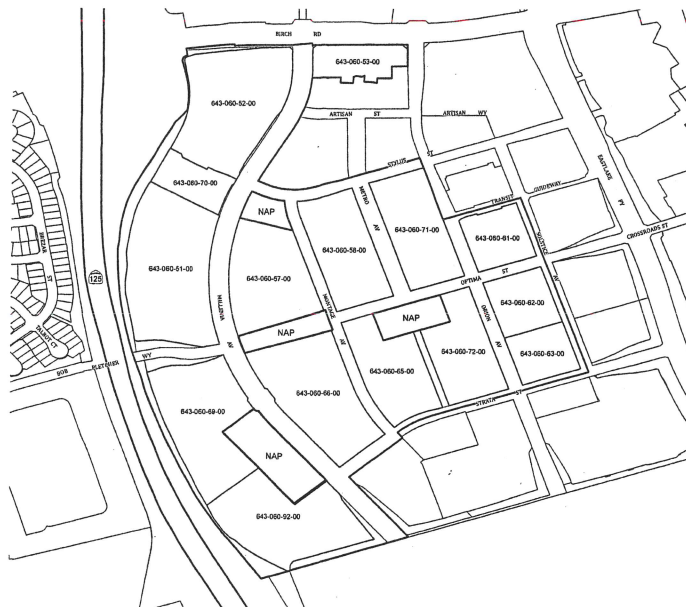

**LEGEND**

- CFD BOUNDARY
- PARCEL LINE
- XXX-XXX-XX-XX ASSESSOR PARCEL NUMBER
- NAP NOT-A-PART

0 600 1,200 2,400 Feet



**BK 47 PG 83**

**2019-7000131**

**2019-7000131**

**BK 47 PG 83**